

## MONTAGEANLEITUNG (ASSEMBLY INSTRUCTIONS)

### KLEIDERSCHRÄNKE WARDROBES

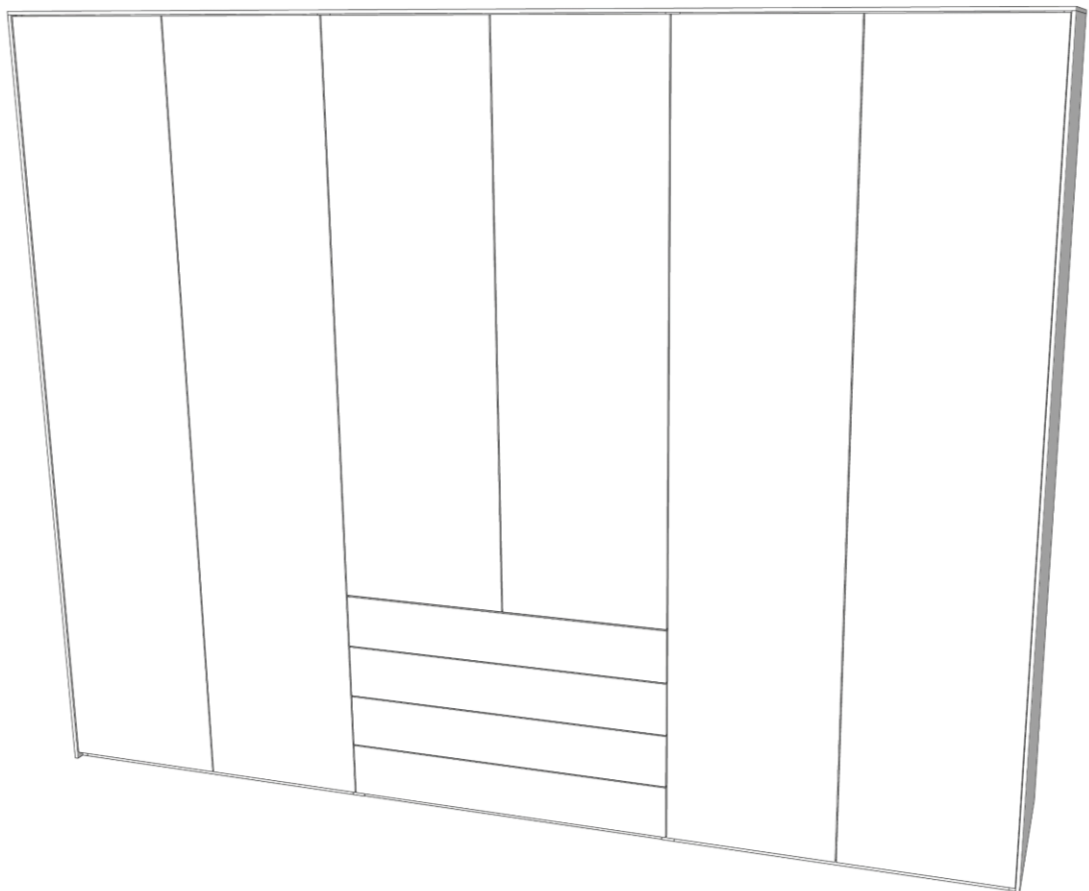

# Inhaltsübersicht

## Table of contents

<b>1.</b>	<b>Montage von Höhenverstellern</b> .....	<b>3</b>
	(Assembly Levellers)	
<b>2.</b>	<b>Montage der Module</b> .....	<b>4</b>
	(Modules Assembly)	
<b>3.</b>	<b>Montages Schubladen</b> .....	<b>8</b>
	(Assembly cabinet drawers)	
<b>4.</b>	<b>Schubladeneinteilung</b> .....	<b>10</b>
	(Drawer placement)	
<b>5.</b>	<b>Platzierung der Böden</b> .....	<b>11</b>
	(Shelves placement)	
<b>6.</b>	<b>Platzierung Abdeckplatte</b> .....	<b>12</b>
	(Placement top)	
<b>7.</b>	<b>Platzierung der Türen</b> .....	<b>13</b>
	(Placement doors)	
<b>8.</b>	<b>Platzierung Schiebetüren</b> .....	<b>16</b>
	(Placement sliding doors)	
<b>9.</b>	<b>Platzierung Falttüren</b> .....	<b>19</b>
	(Placement Folding doors)	
<b>10.</b>	<b>Platzierung Kleiderstangen</b> .....	<b>23</b>
	(Placement hanging rod)	
<b>11.</b>	<b>Platzierung der Griffe</b> .....	<b>25</b>
	(Placement handles)	
<b>12.</b>	<b>Anschluss-LEDs</b> .....	<b>26</b>
	(Connection LEDs)	

# D: ANWEISUNGEN FÜR DIE MONTAGE BEFOLGEN

EN: FOLLOW INSTRUCTIONS IF NECESSARY FOR ASSEMBLY

## 1. Montage von Höhenstellern Assembly Levellers

Nur eine Seite  
Only one side

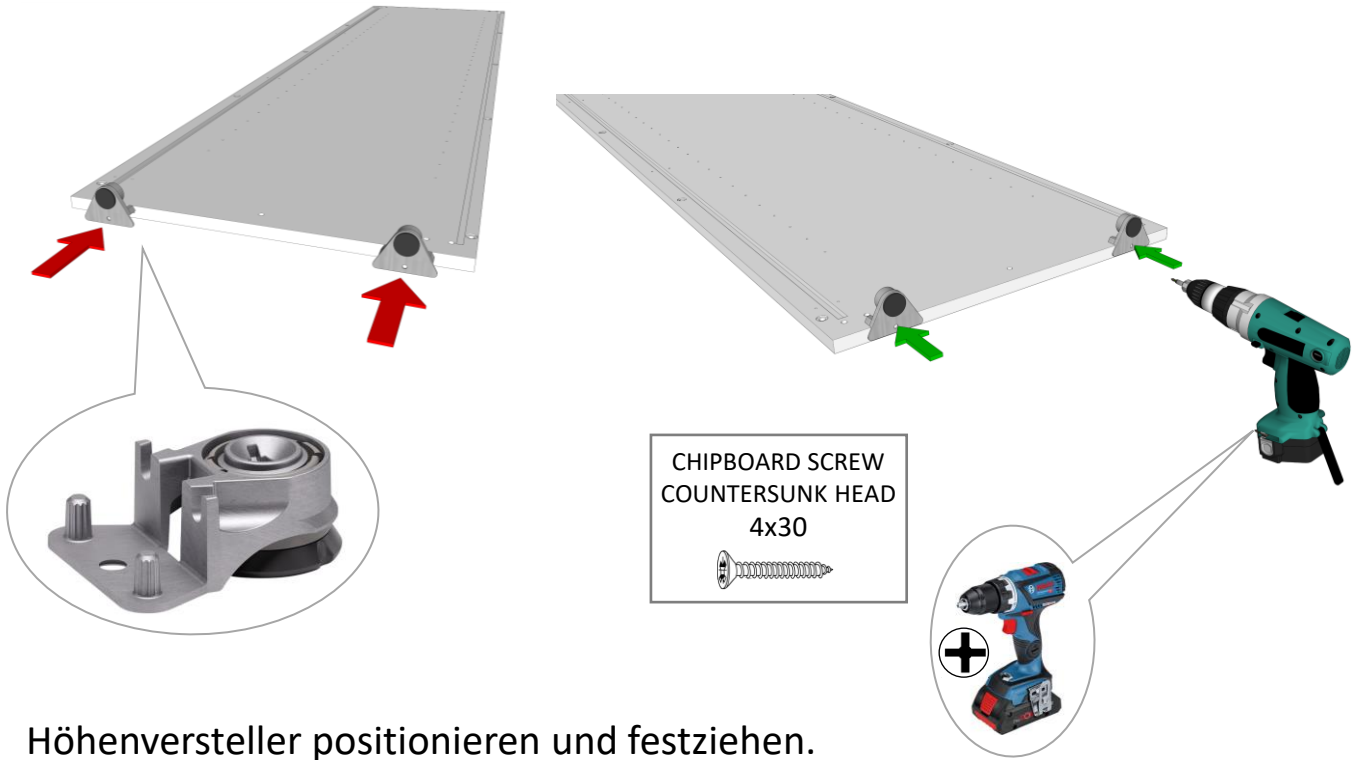

CHIPBOARD SCREW  
COUNTERSUNK HEAD  
4x30

Höhenversteller positionieren und festziehen.  
Position levellers and tighten.

Beide Seiten  
Both Sides

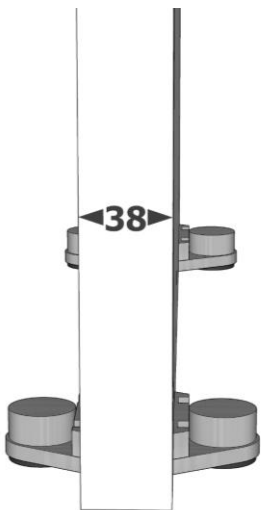

Innenseiten (38mm)  
Höhenversteller Auf Beiden Seiten.  
Interior sides (38mm) takes leveller  
two sides.

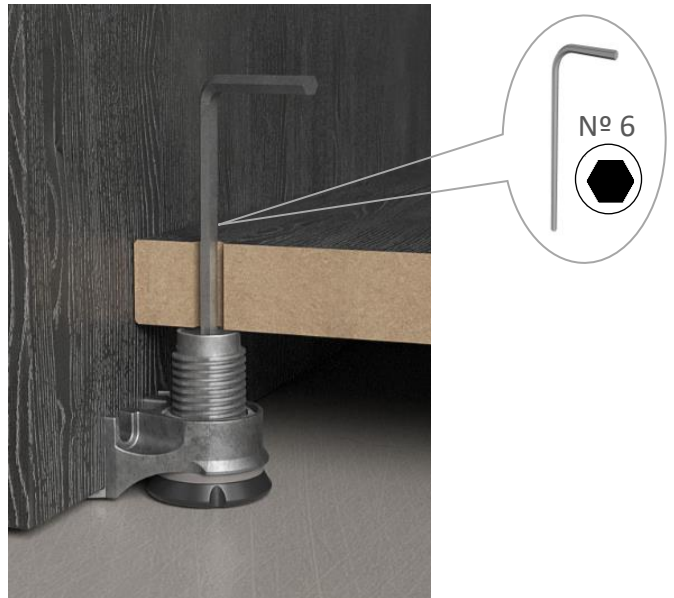

Höheneinstellung.  
Tuning leveller after mounting on the  
base.

## 2. Montage der Module

### Modules Assembly

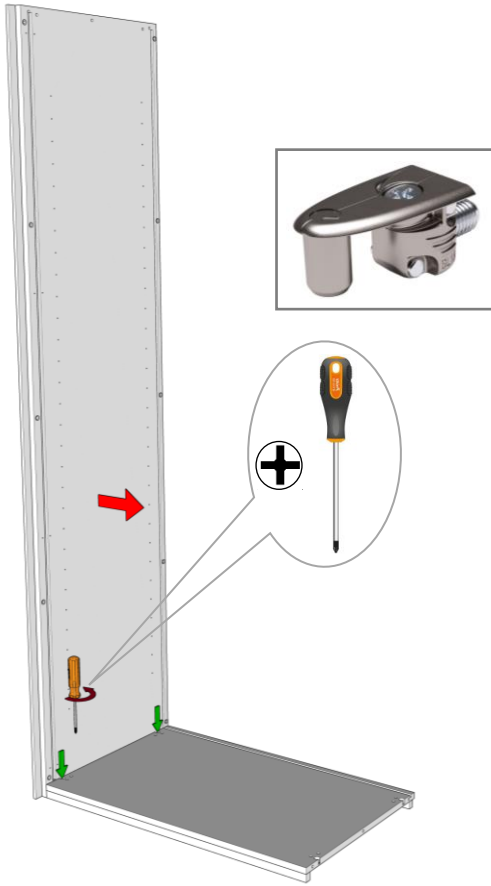

Die Seiten anbringen und festziehen.  
Position sides and tighten.

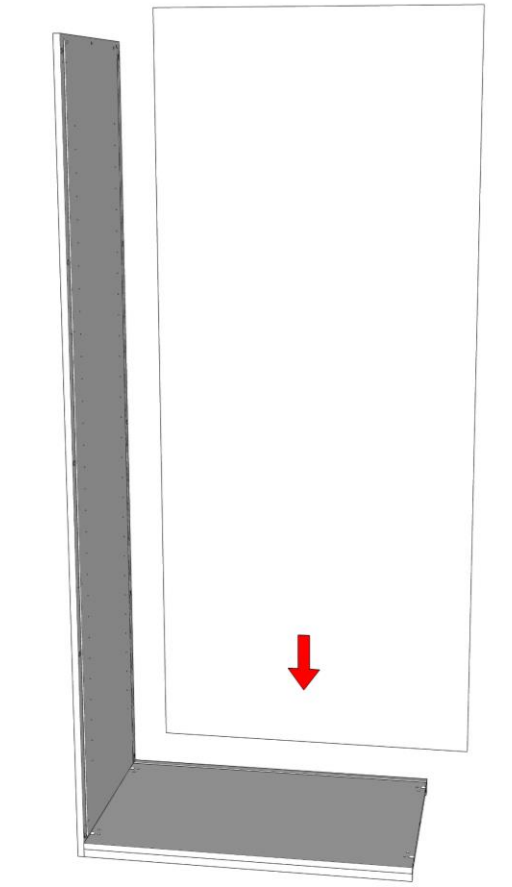

Rückwand in Position bringen.  
Put the back in position.

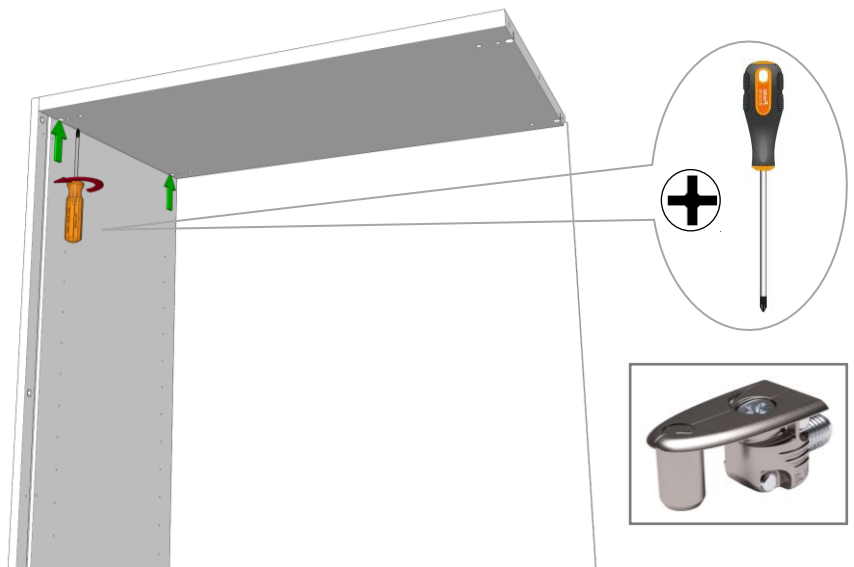
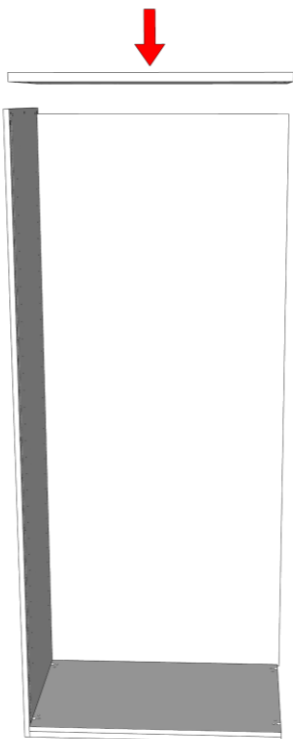

Den Deckel aufsetzen und festziehen.  
Place top and tighten.

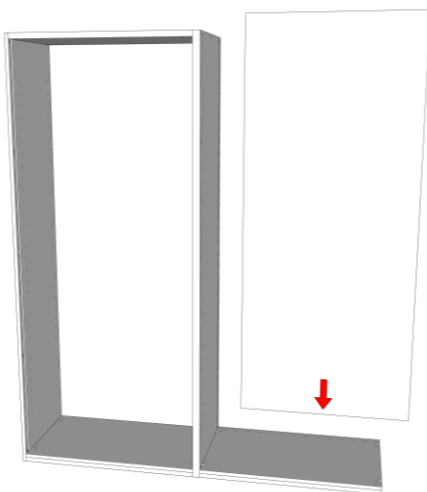
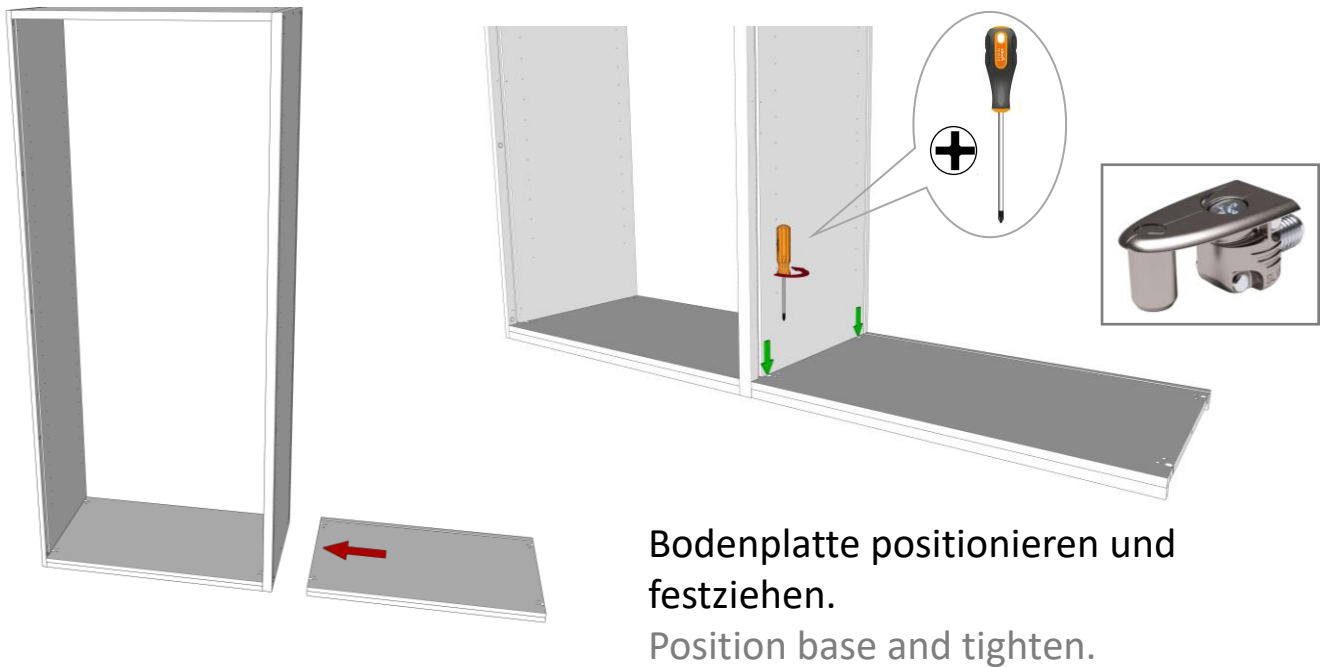
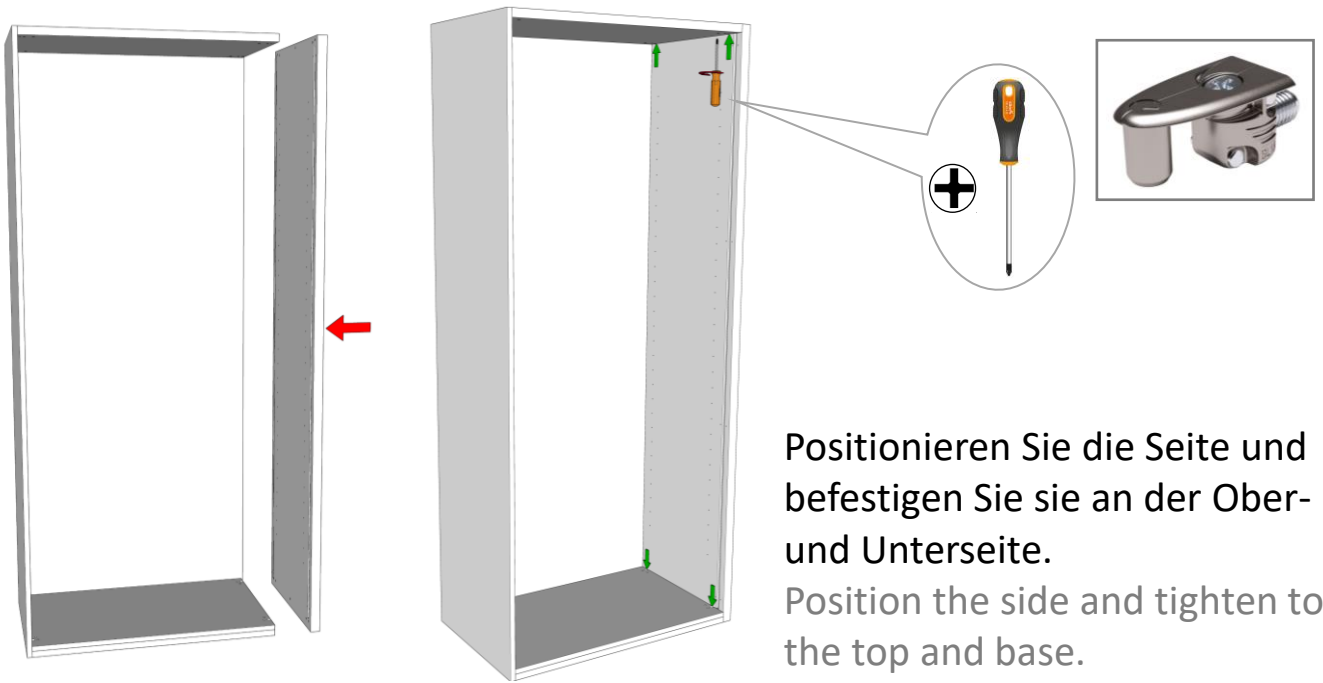

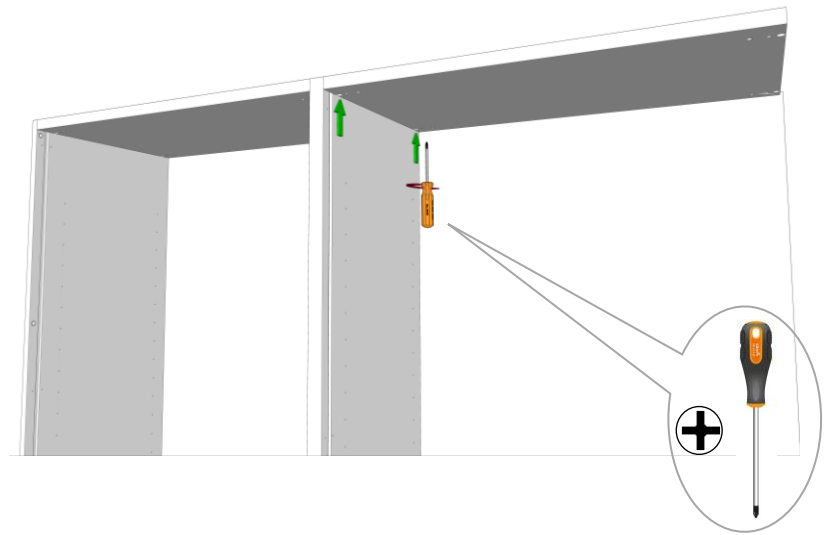
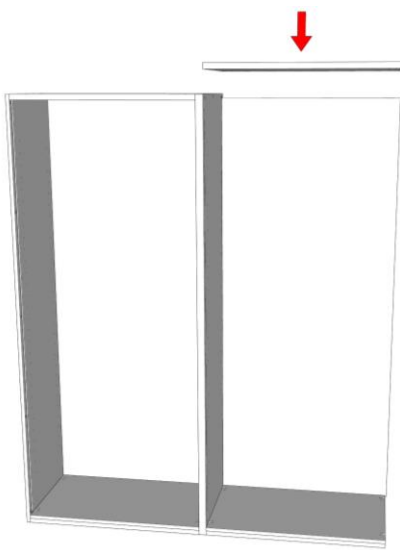

Oberteil aufsetzen und festziehen.  
Position top and tighten.

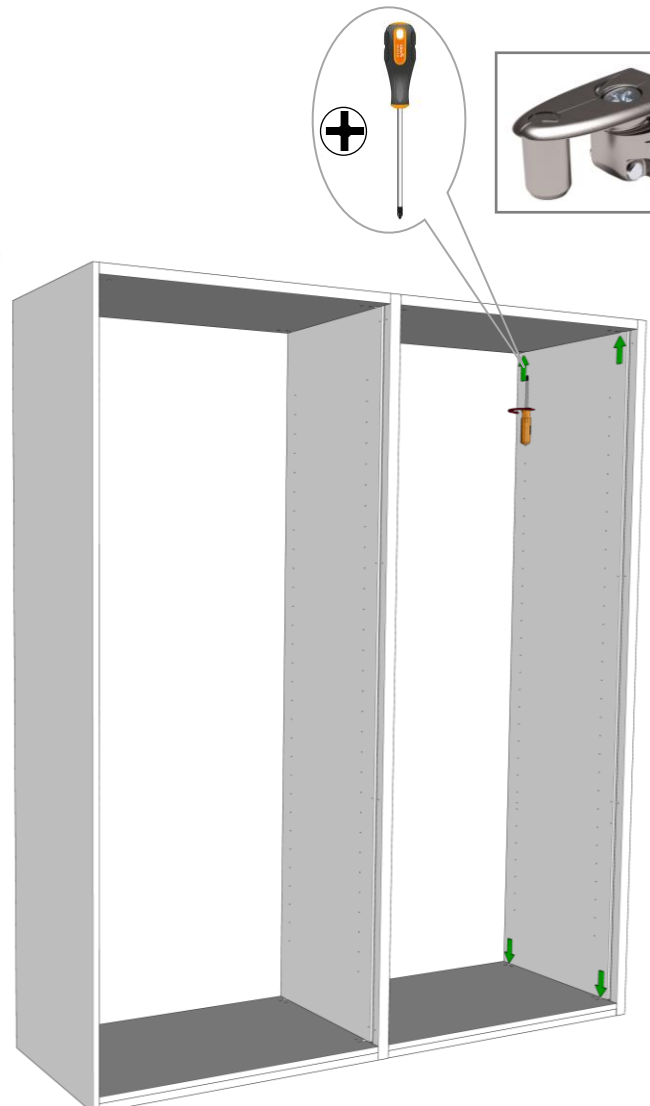
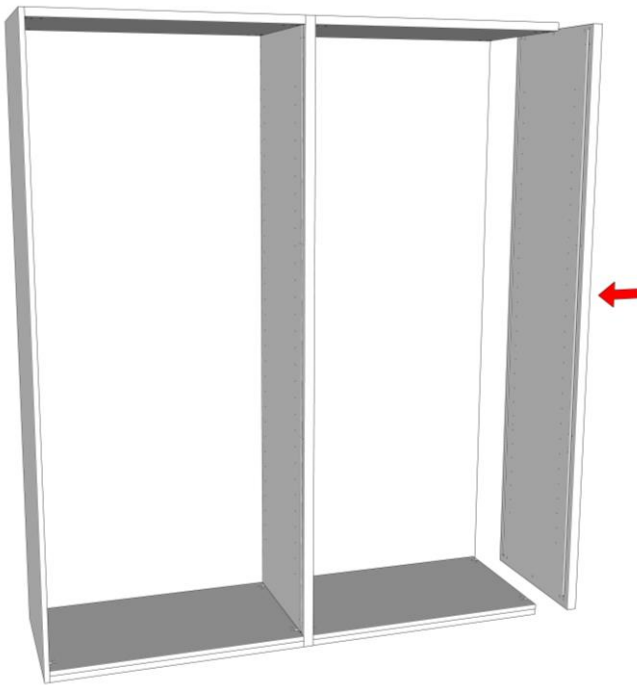

Positionieren Sie die Seite und  
befestigen Sie sie an der Ober- und  
Unterseite.

Position the side and tighten to the  
top and base.



**Bodenplatte positionieren und festziehen.**  
Position base and tighten.

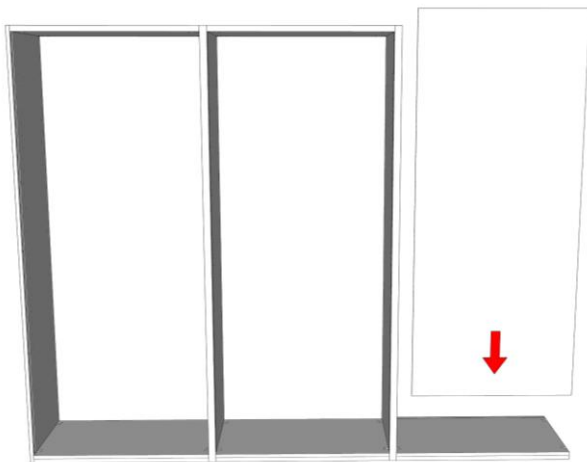

**Rückwand in Position bringen.**  
Put the back in position.

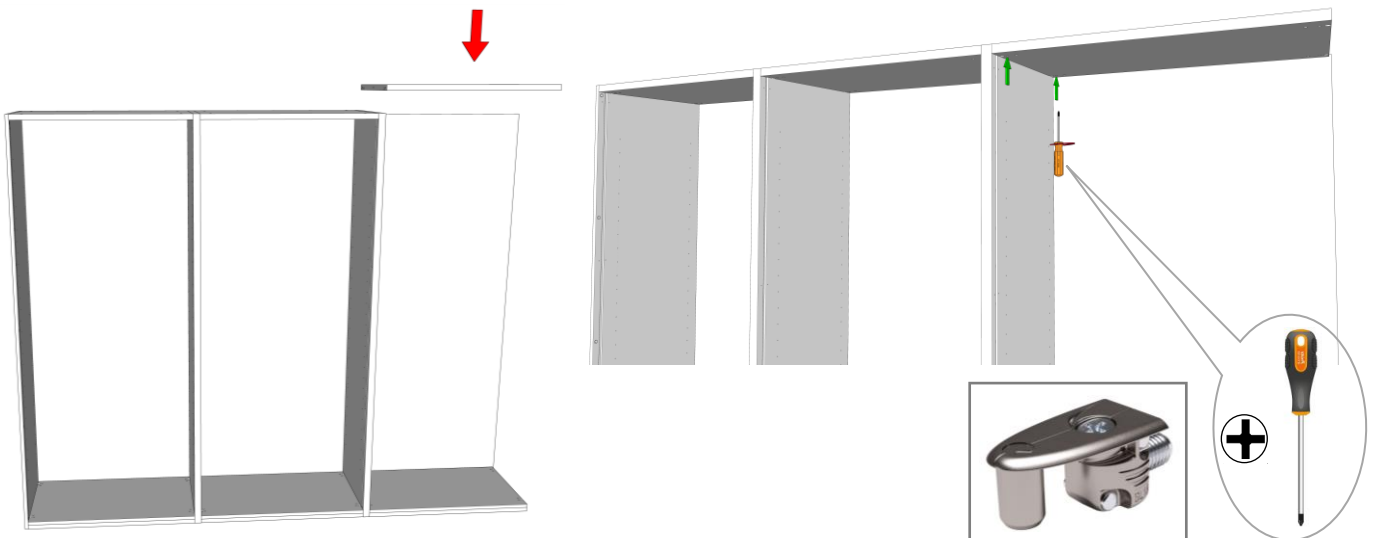

**Oberteil aufsetzen und festziehen.**  
Position top and tighten.

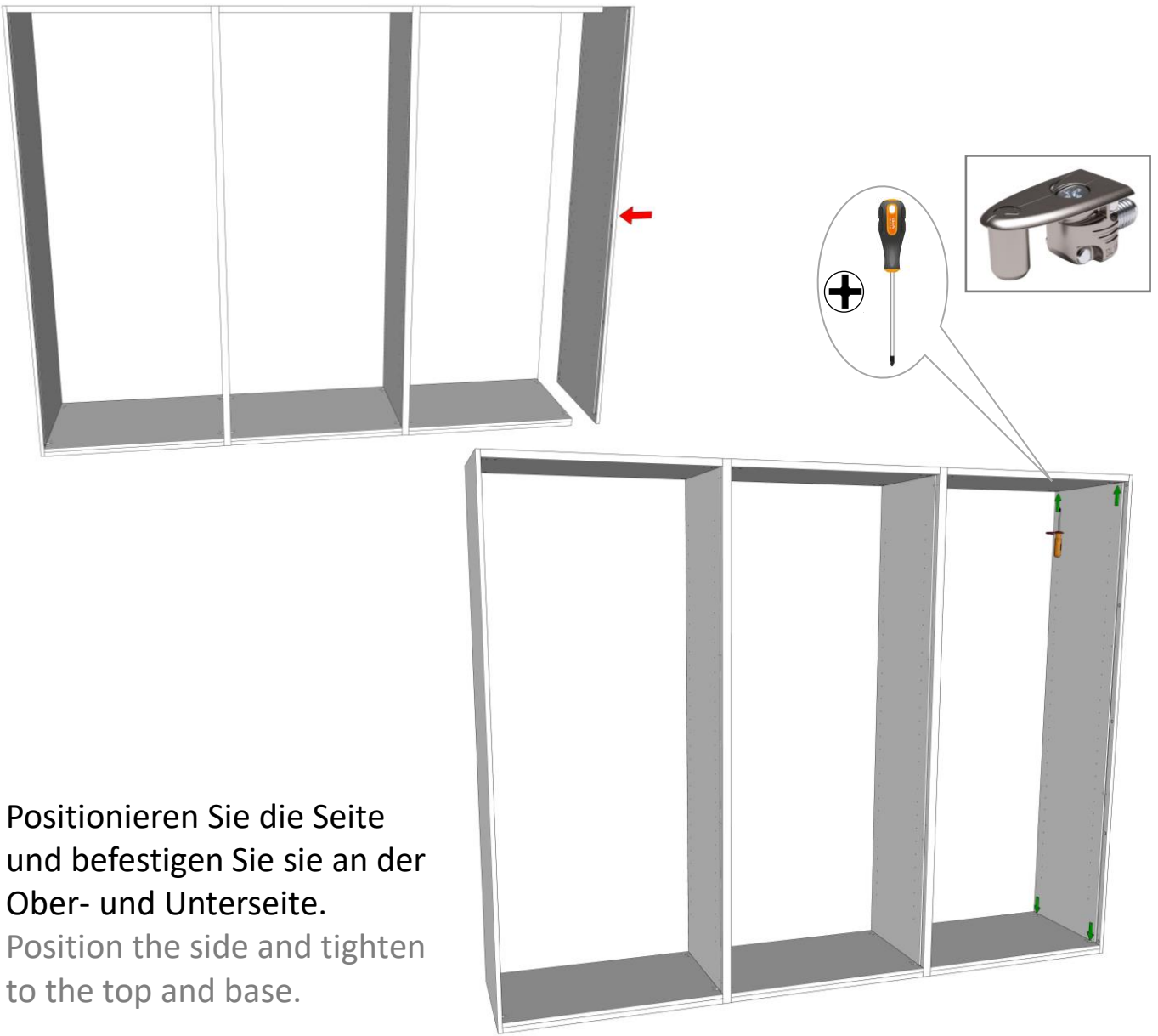

Positionieren Sie die Seite und befestigen Sie sie an der Ober- und Unterseite.  
Position the side and tighten to the top and base.

### 3. Montage Schubladen Assembly cabinet drawers

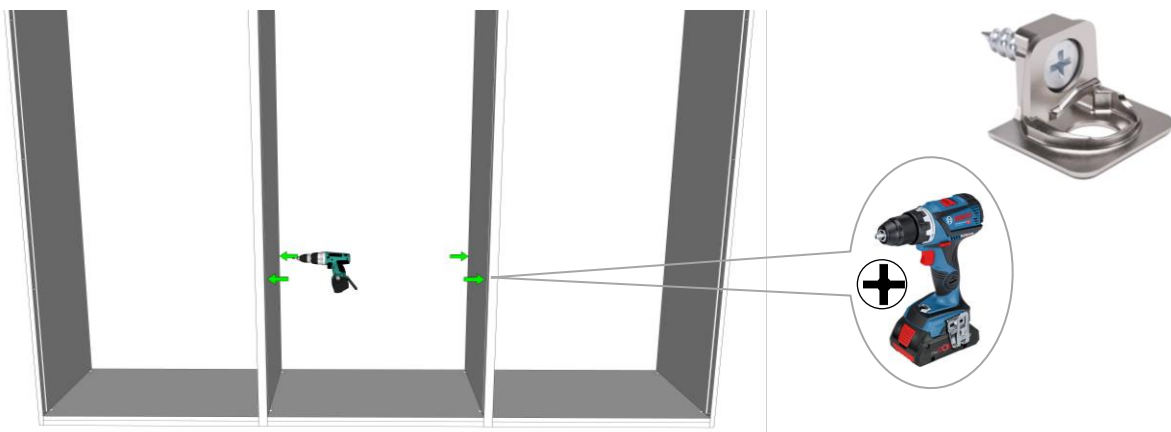

Platzieren Sie rafx-Beschläge (Schrankschubladen).  
Place rafx hardware (cabinet drawers).



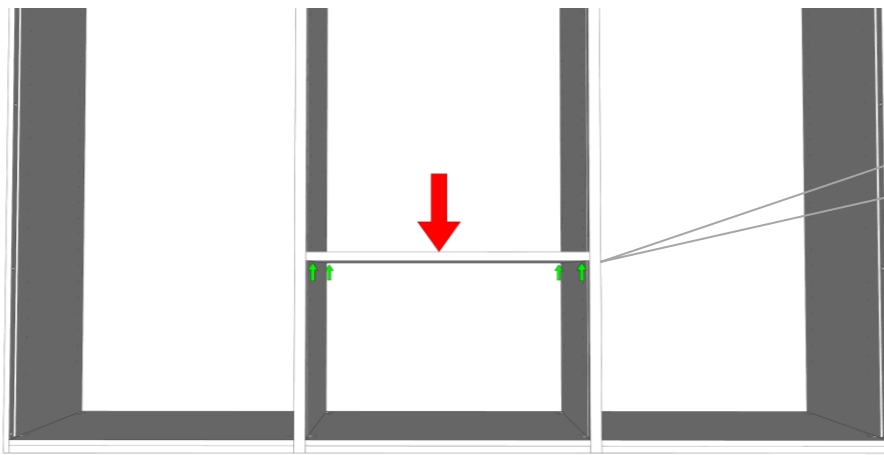

Den Boden aufsetzen und festziehen.  
Place top and tighten.

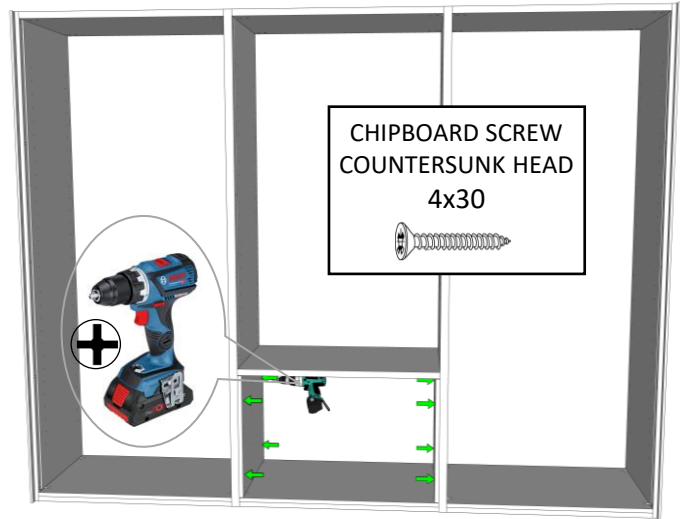
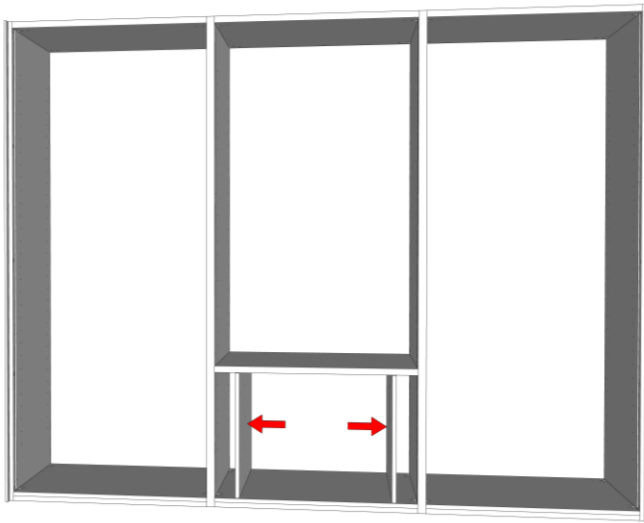

CHIPBOARD SCREW  
COUNTERSUNK HEAD  
4x30

Seiten positionieren und festziehen.  
Position sides and tighten.

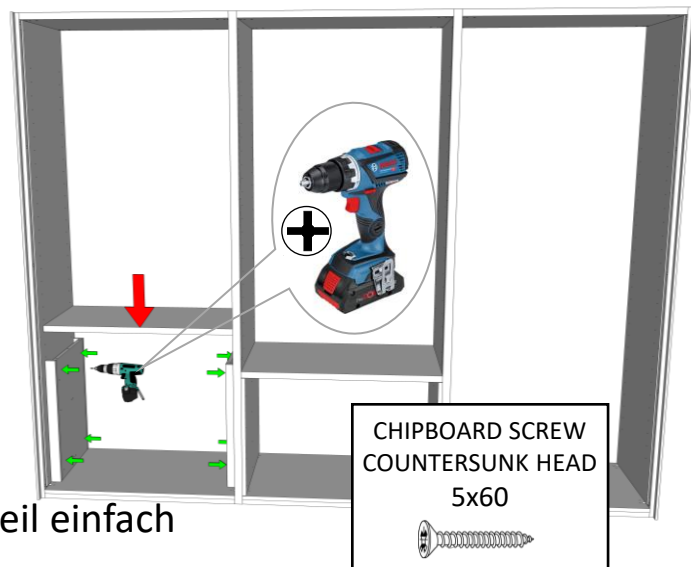
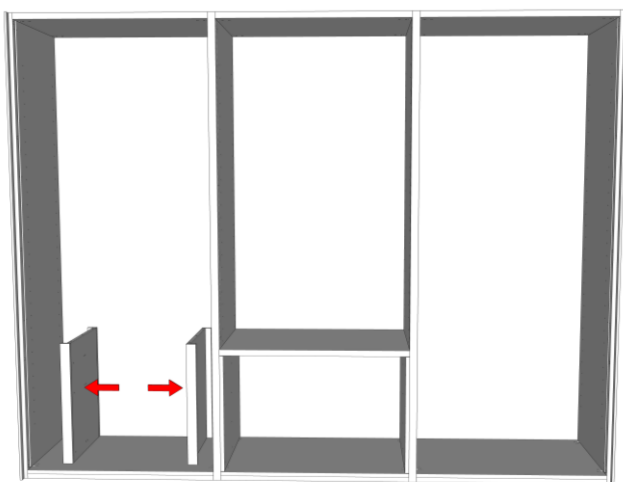

CHIPBOARD SCREW  
COUNTERSUNK HEAD  
5x60

Seiten anbringen und festziehen. Oberteil einfach aufsetzen.  
Position sides and tighten.  
Top just put down.

# 4. Schubladeneinteilung

Drawer placement

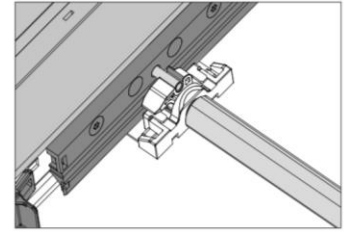
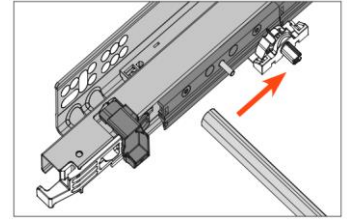
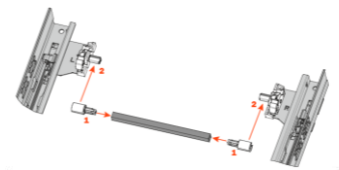
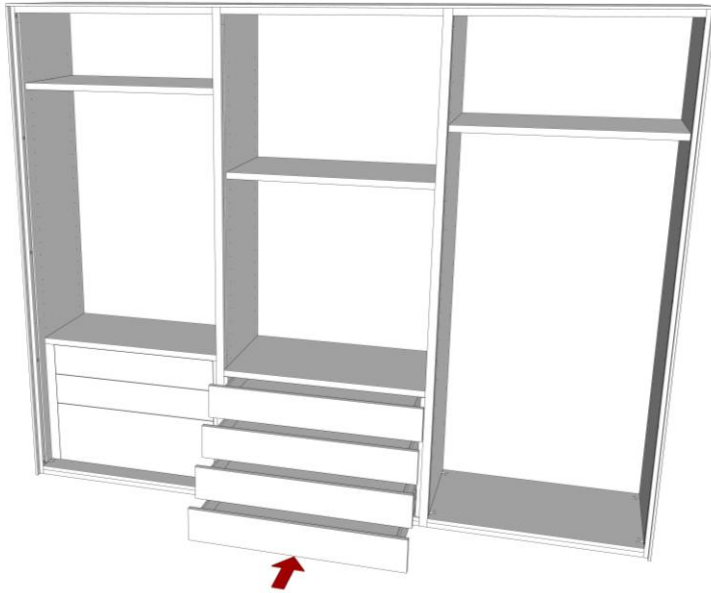
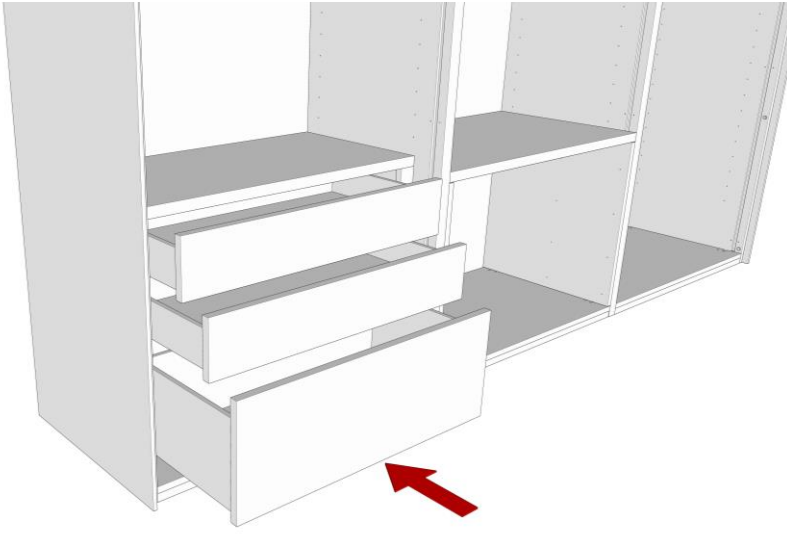

Synchronisierung Einsetzen.  
Placement synchroniser.

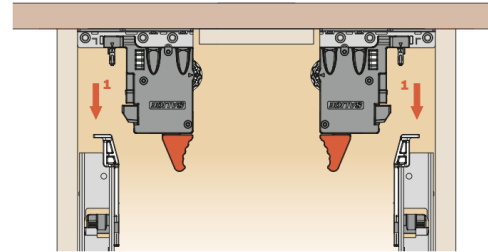
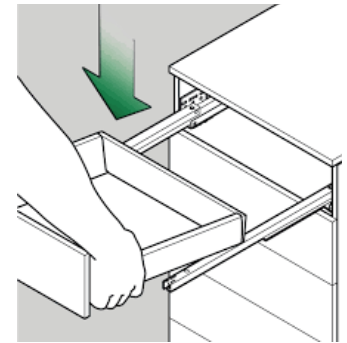

Einsetzen der Schublade in die  
Führungsschienen.  
Inserting drawer in the runners.

Schublade einschieben und einstellen.  
Place and regular drawer ( if you need).

## Einstellungen | Adjustments

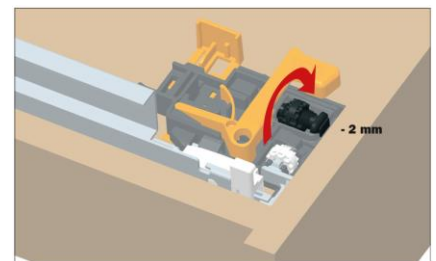
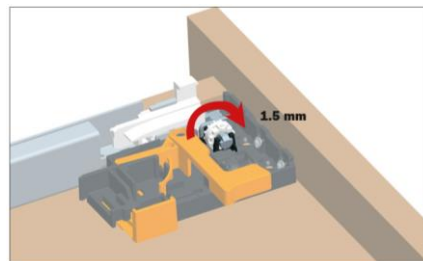
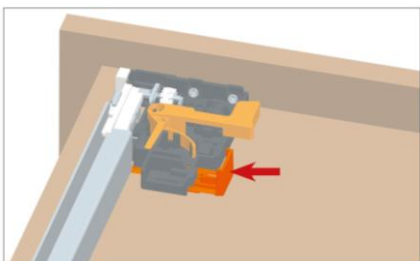
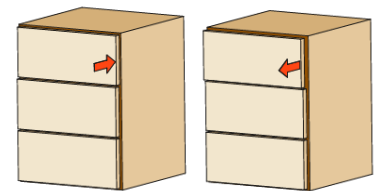
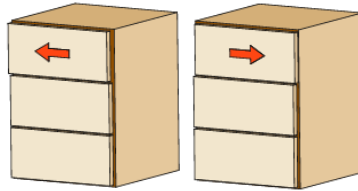
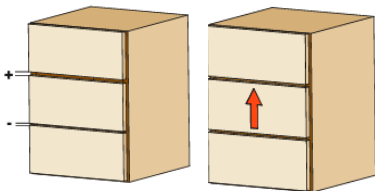

## 5. Platzierung der Böden

### Shelves placement

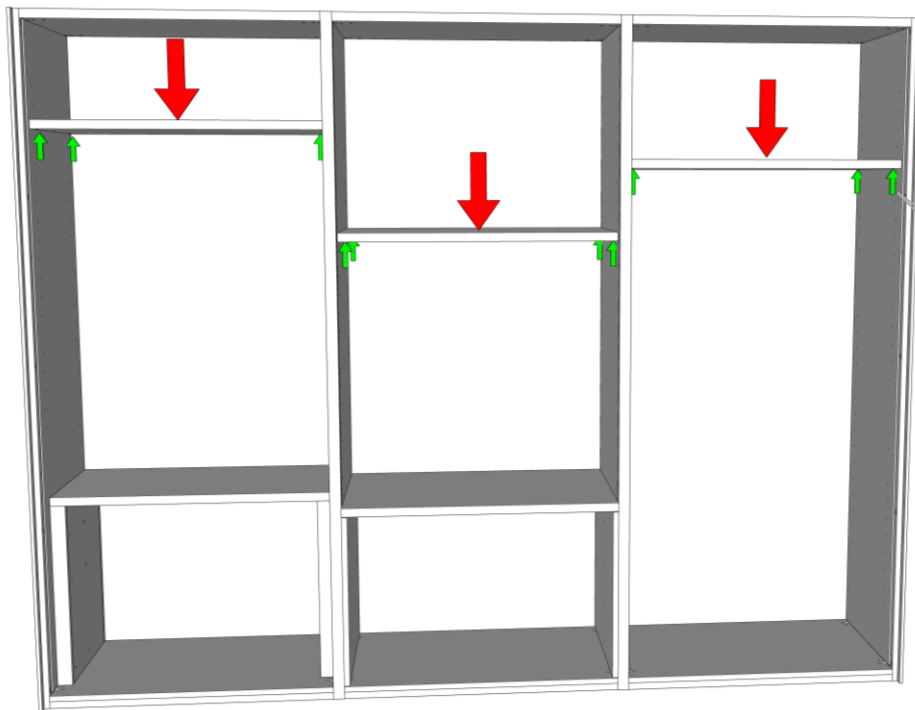
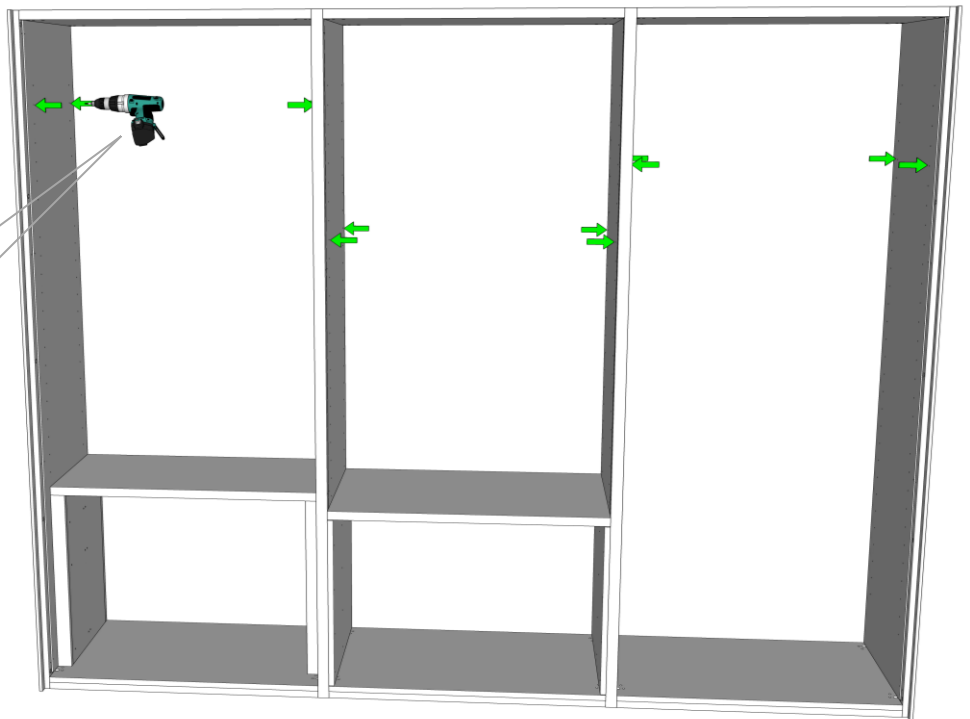

Positionieren Sie die verstellbaren Einlegeböden (Position Ihrer Wahl). Ziehen Sie nach der Positionierung die Befestigungselemente fest, um den Schrank zu sichern. Es wird nicht empfohlen, die Position nach dem Aufstellen zu ändern.

Position adjustable shelves (position of your choice).

After positioning tighten fix hardware to secure the closet.

We do not recommend changing positions after placement.



## 6. Platzierung oben

Placement top

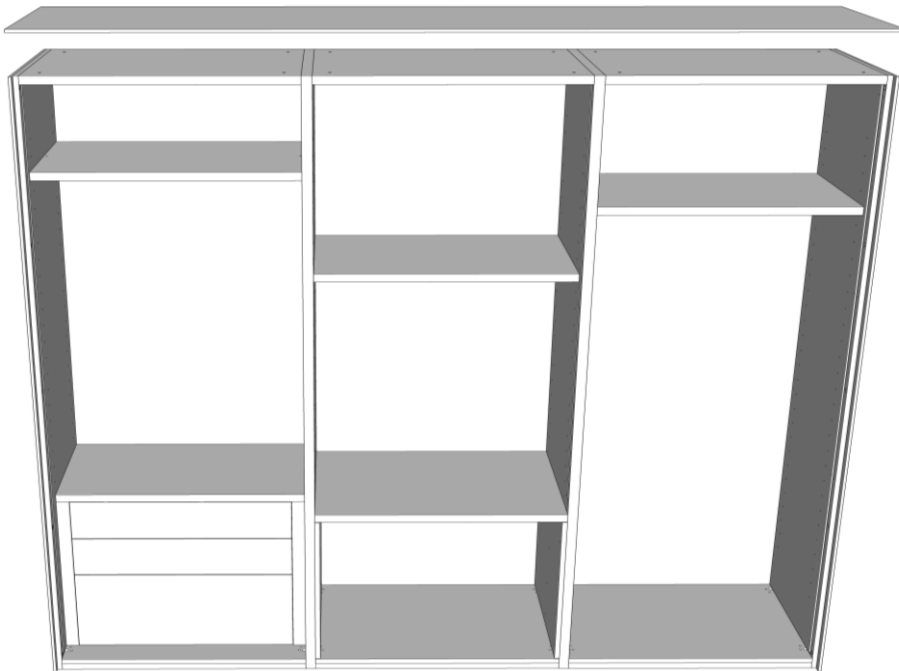

SCREW WITH FLATTENED  
HALF ROUND  
M4x35

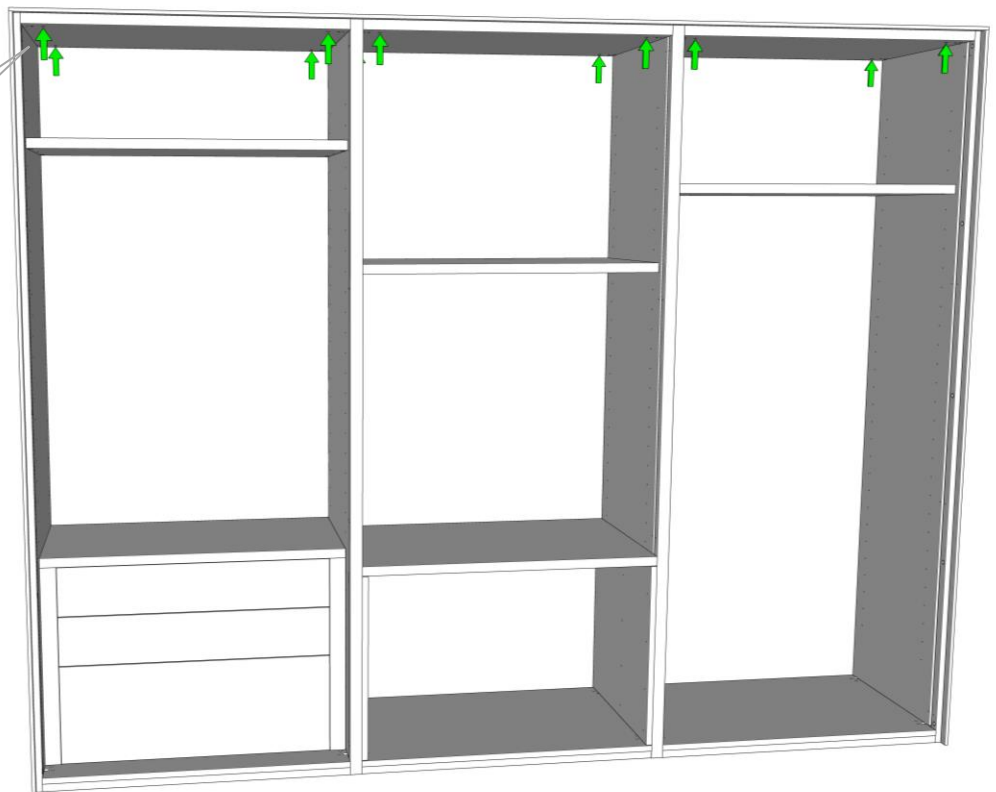

Deckel aufsetzen und festziehen.

Place top and tighten.

## 7. Platzierung der Türen

Placement doors

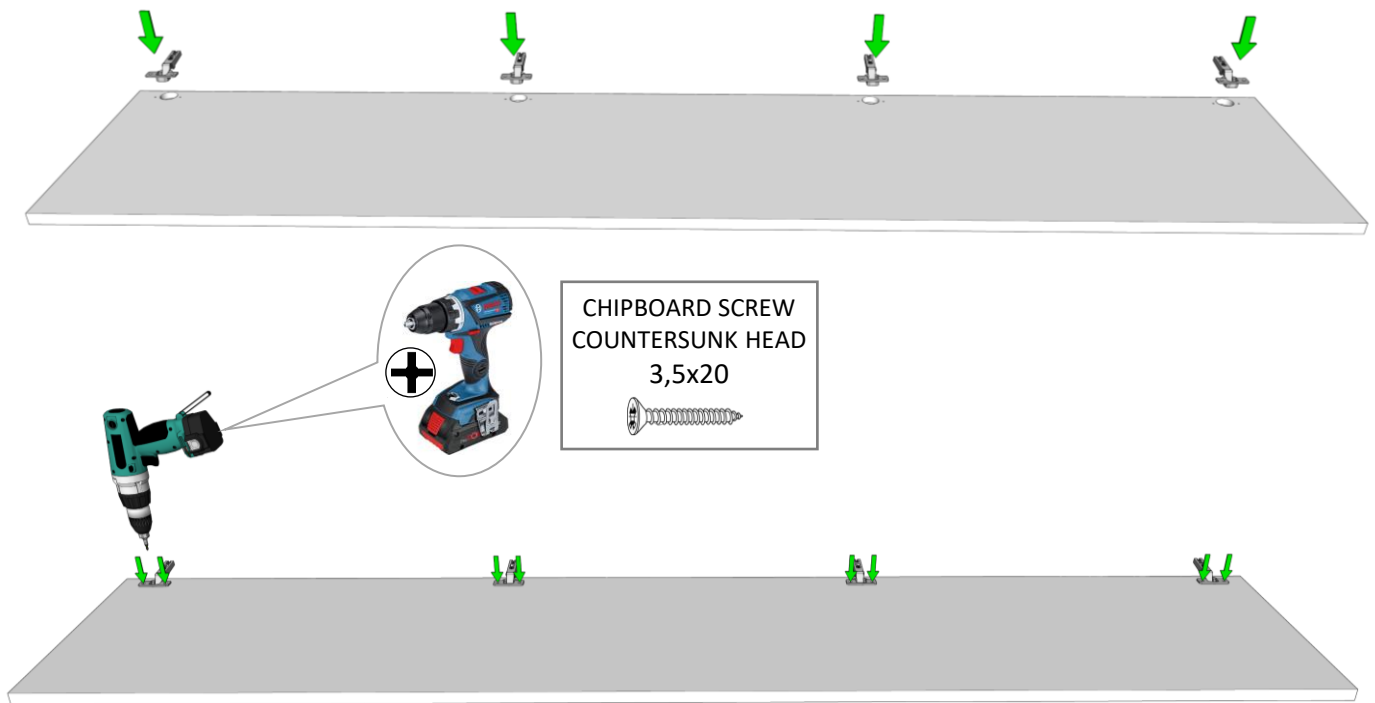

Scharniere positionieren und festziehen.

Position hinges and tighten.

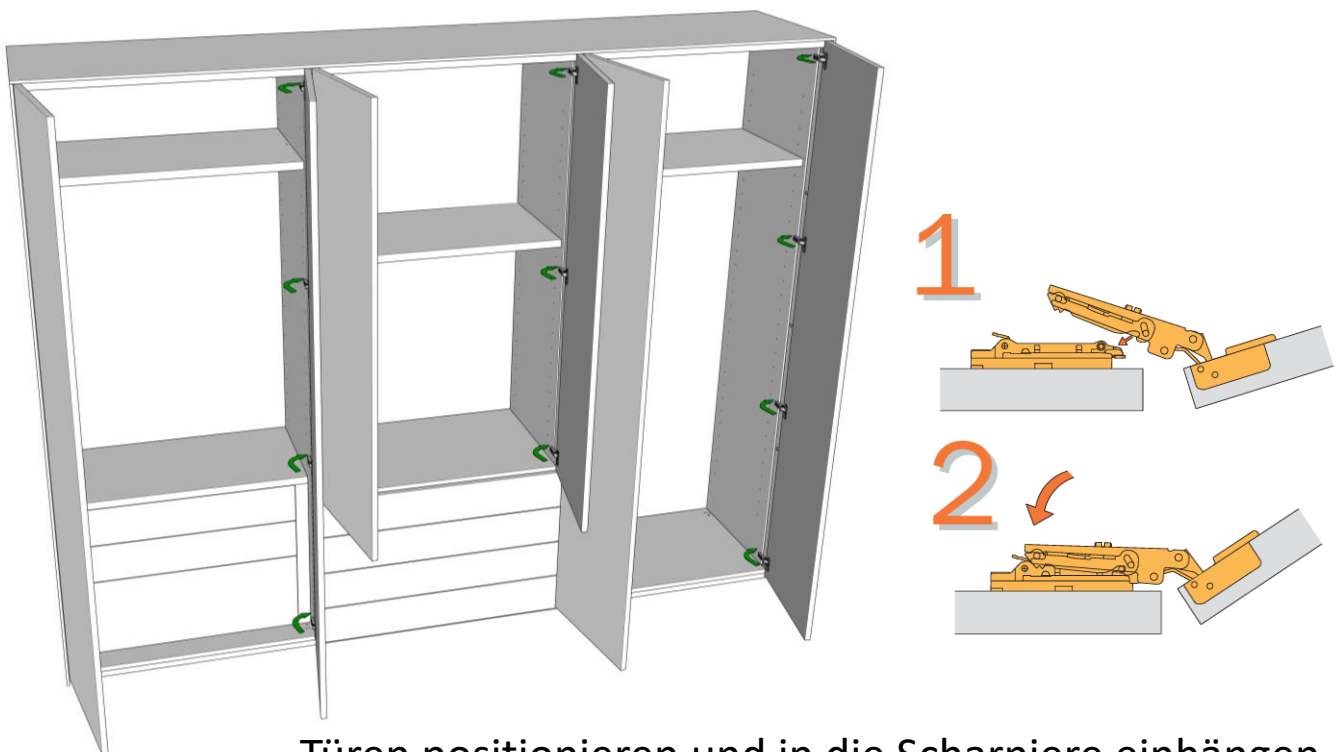

Türen positionieren und in die Scharniere einhängen.  
Position doors and clip on hinges.

2350-2600

Türhöhe 2350 bis 2600  
Door's height 2350 to 2600

Push-Pull System  
2 Scharniere 110° - C2A4A99  
2 hinges 110° - C2A4A99

Push-Pull System  
4 Scharniere 110° - C2A6A99  
4 hinges 110° - C2A6A99

2350-2600

Türhöhe 2350 bis 2600  
Door's height 2350 to 2600

Smove  
6 Scharniere 110° - C7A6AE9  
6 hinges 110° - C7A6AE9

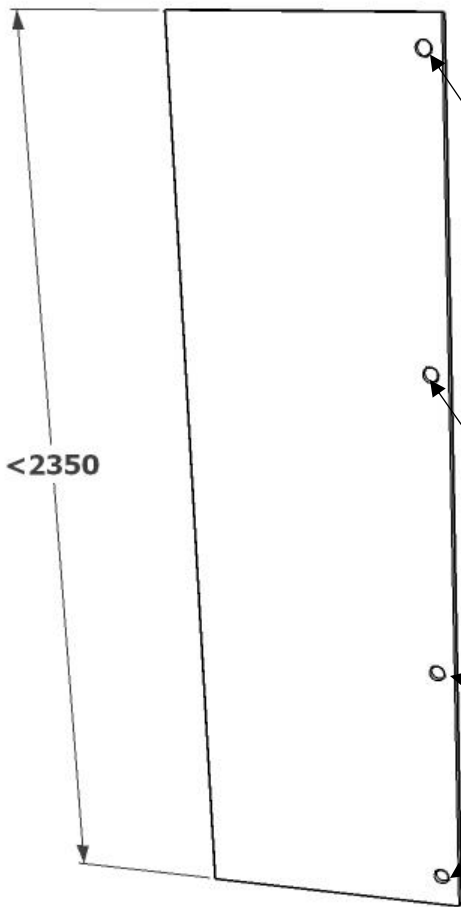

Türen mit einer Höhe von weniger als 2350  
Doors with height less than 2350

Push-Pull System  
1 Scharniere 110° - C2A4A99  
1 hinges 110° - C2A4A99

Push-Pull System  
3 Scharniere 110° - C2A6A99  
3 hinges 110° - C2A6A99

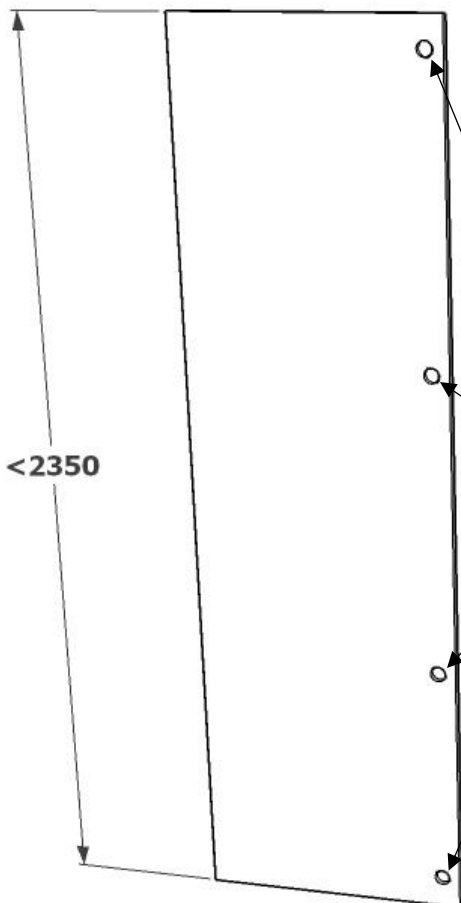

Türen mit einer Höhe von weniger als 2350  
Doors with height less than 2350

Smove  
4 Scharniere 110° - C7A6AE9  
4 hinges 110° - C7A6AE9

## 8. Platzierung Schiebetüren

Placement sliding doors

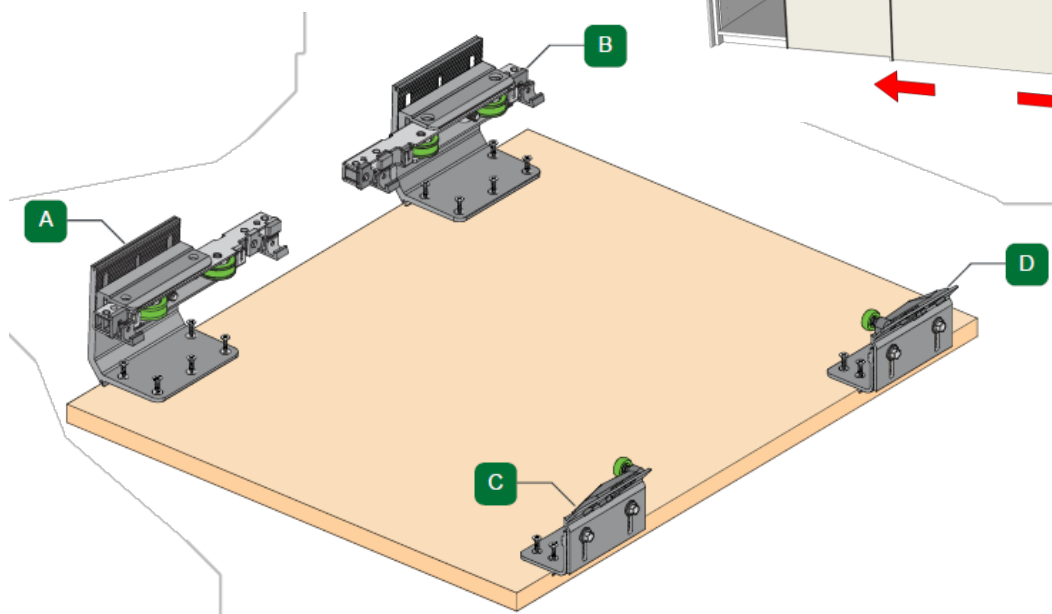
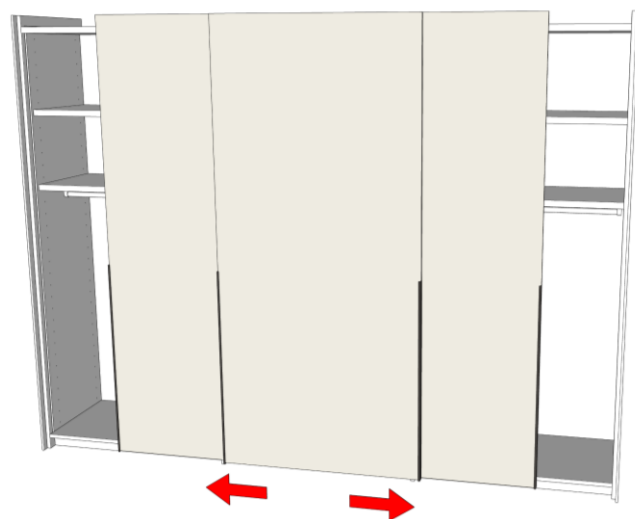

Installieren Sie das Zubehör für die Vordere Schiebetür.  
Install front door accessories.

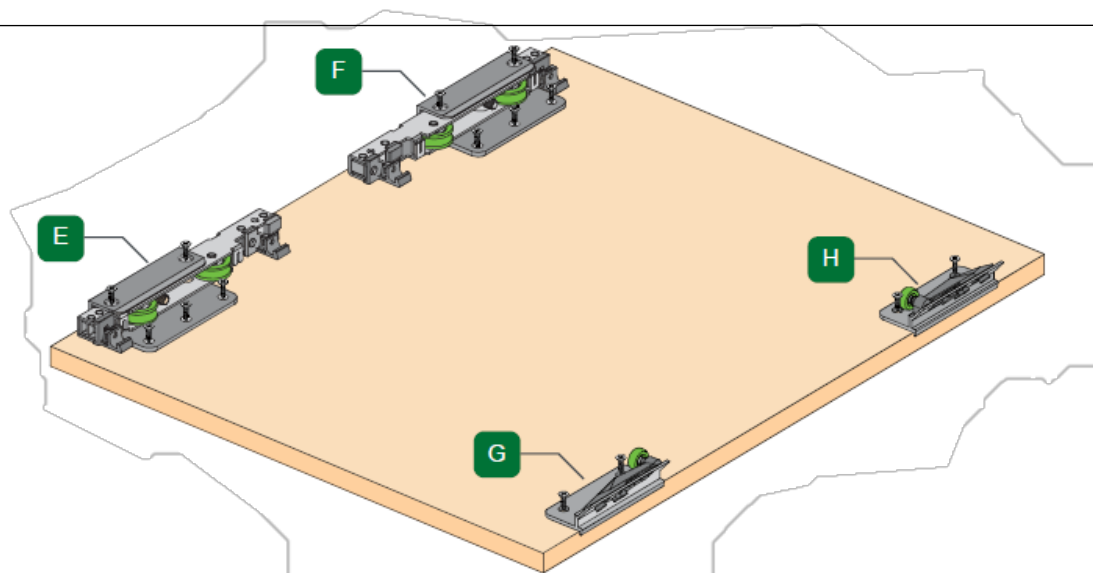

Installieren Sie das Zubehör für die Hintere Schiebetür.  
Install back door accessories.



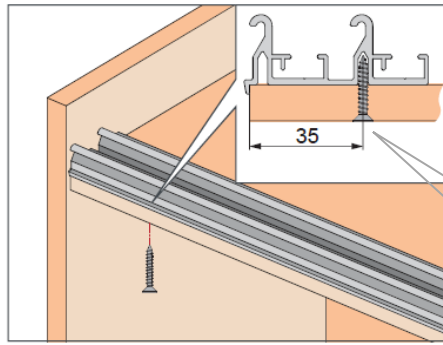
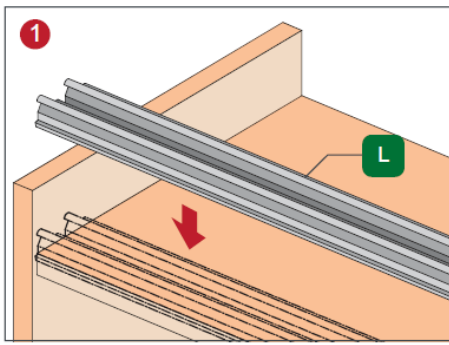

CHIPBOARD SCREW  
COUNTERSUNK HEAD  
4x38



Laufschiene montieren.  
Install top track.

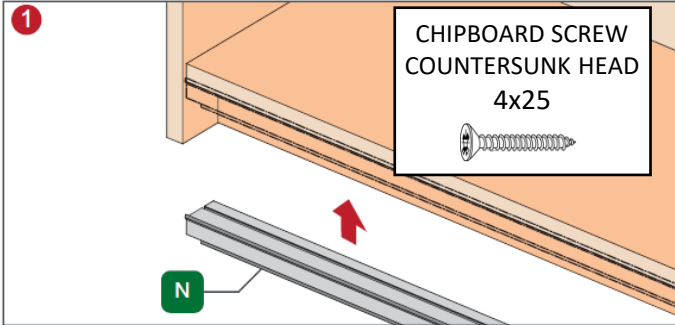

CHIPBOARD SCREW  
COUNTERSUNK HEAD  
4x25

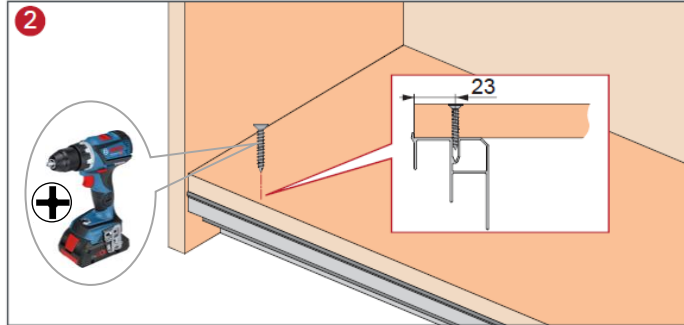

Untere Schiene einbauen.  
Install bottom track.

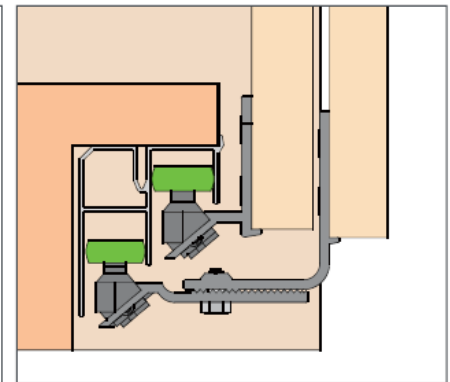
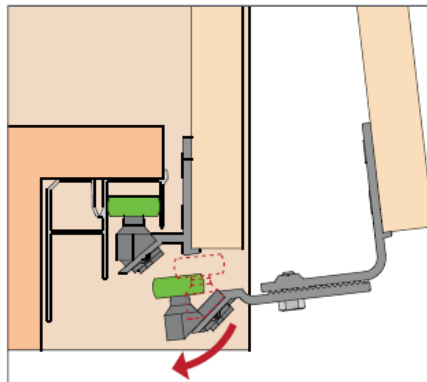
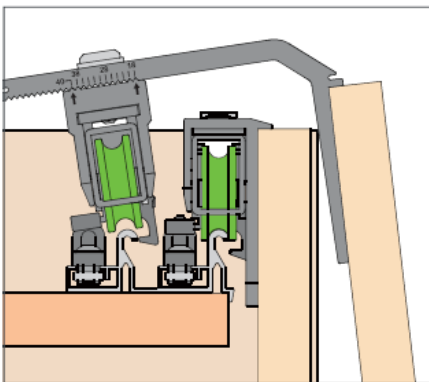
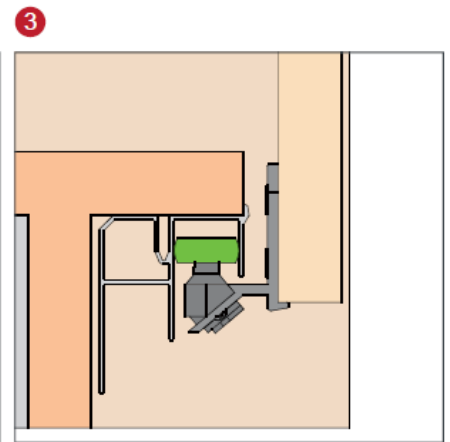
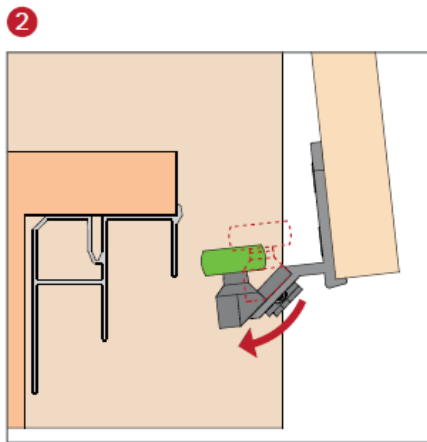
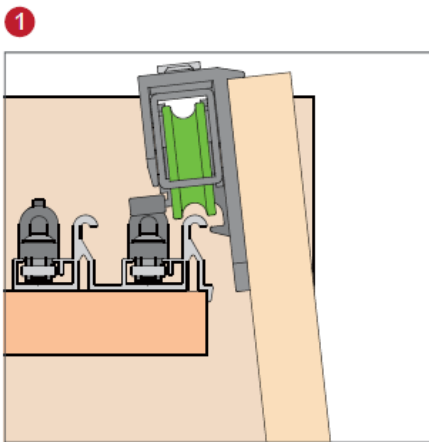

Türen in Position bringen.  
Install doors on position.

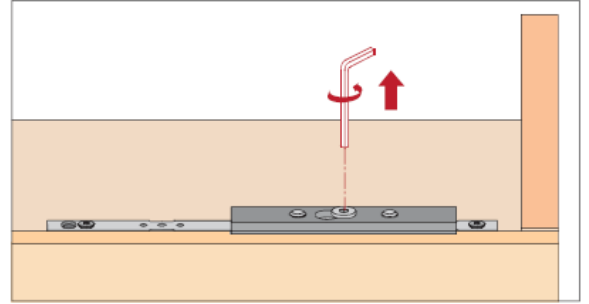
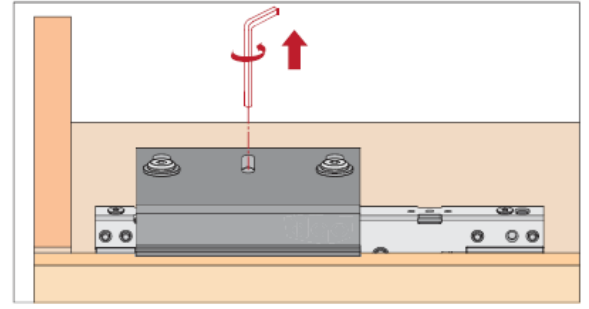
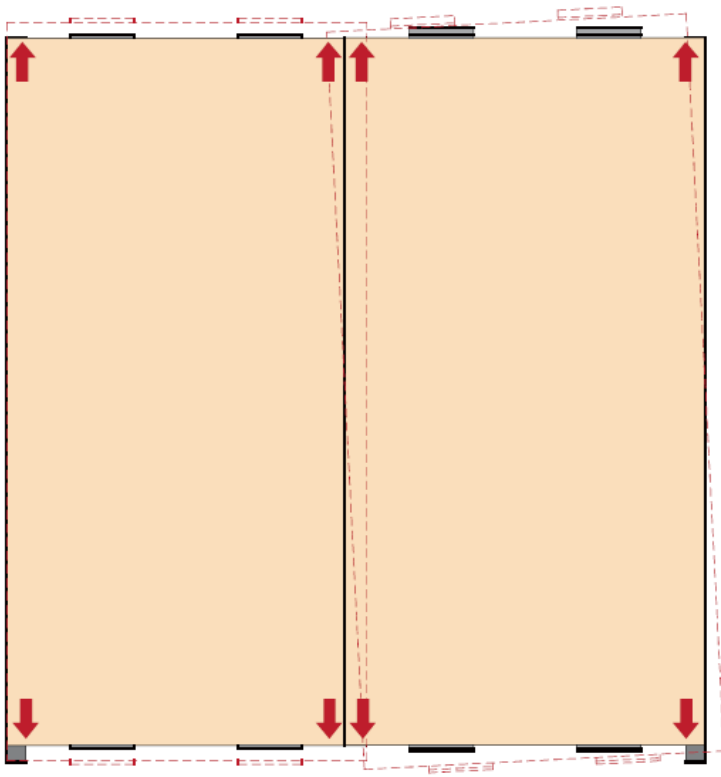

Türhöhenverstellung.  
Door height adjustment.

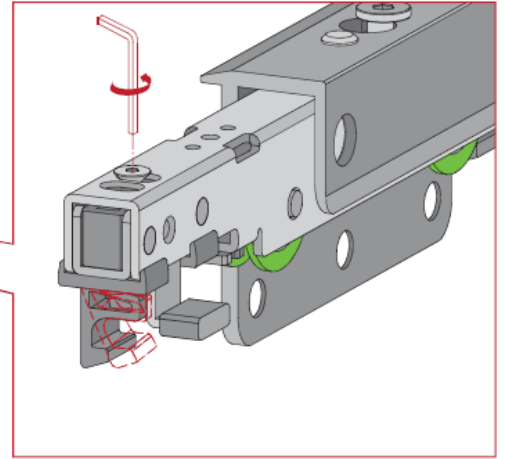
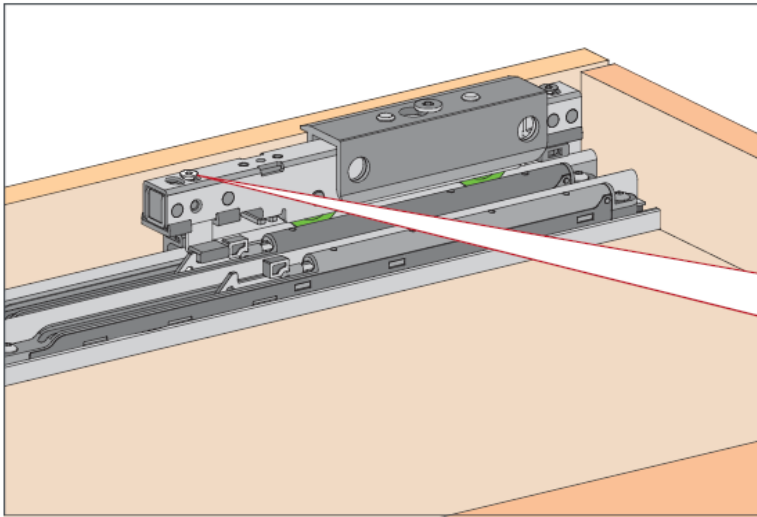

Einstellung der Sicherung.  
Anti-jump hook adjustment.

# 9. Montage Falltüren

Placement Folding doors

Installieren Sie die Schienenbeschläge

Install the track fittings

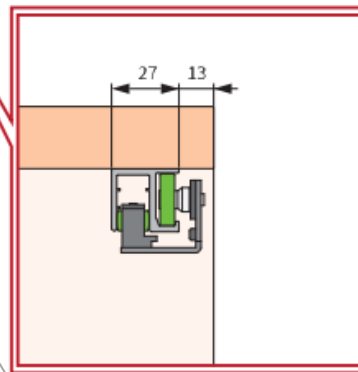
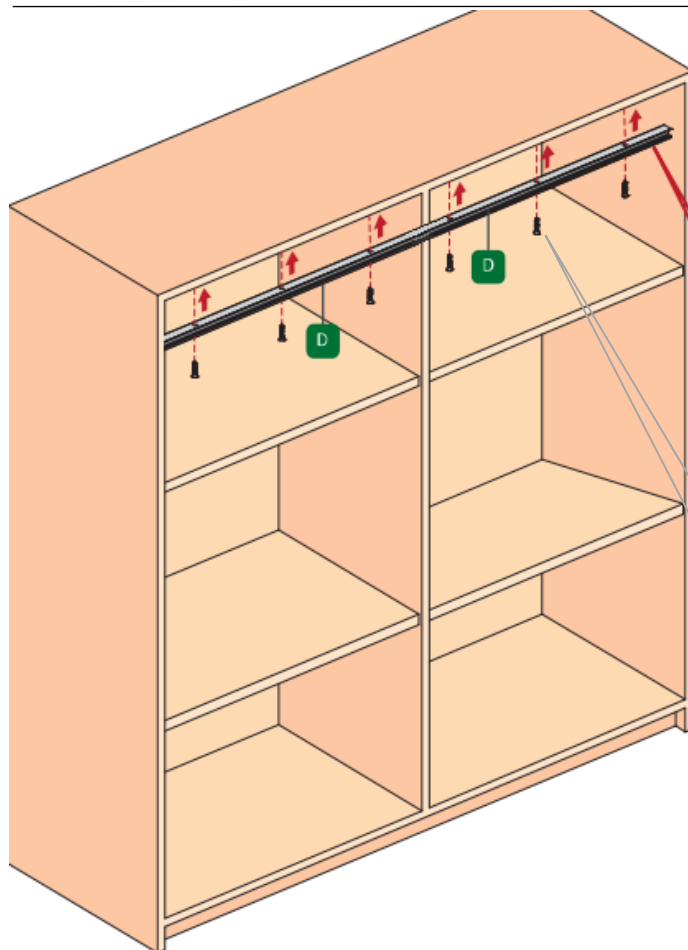
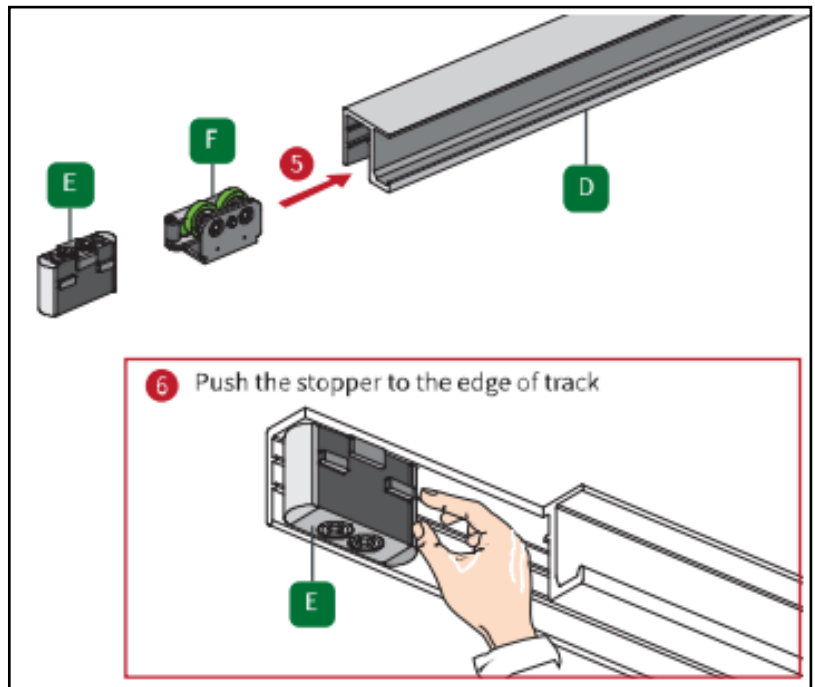
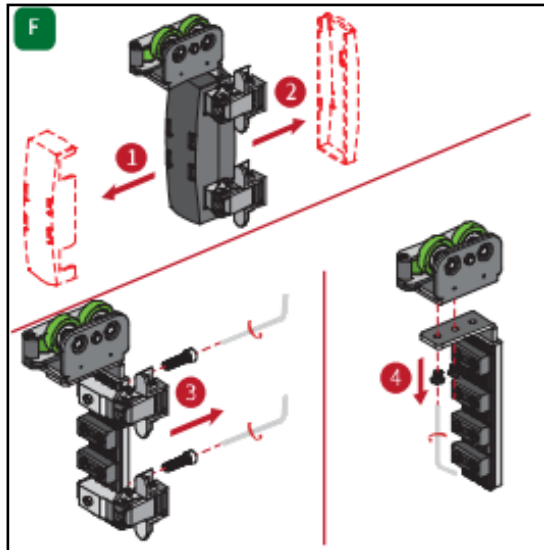

CHIPBOARD SCREW  
COUNTERSUNK HEAD  
3,5x20



Spur installieren  
Install track

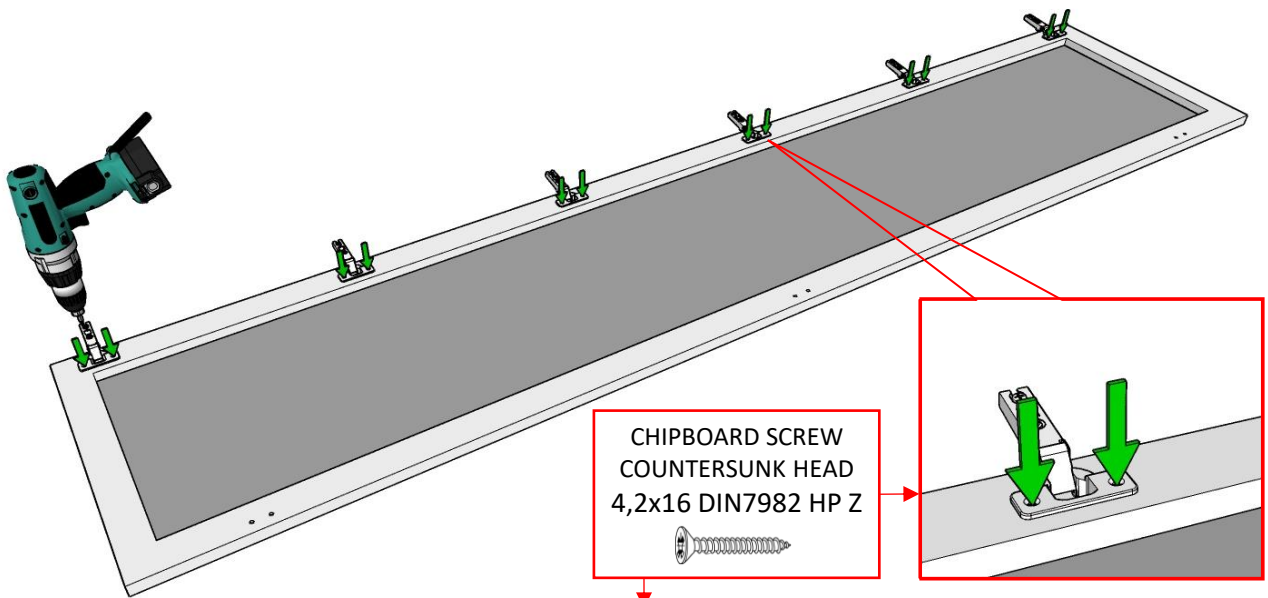

CHIPBOARD SCREW  
COUNTERSUNK HEAD  
4,2x16 DIN7982 HP Z

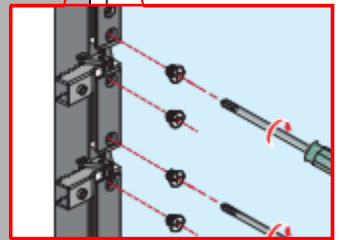
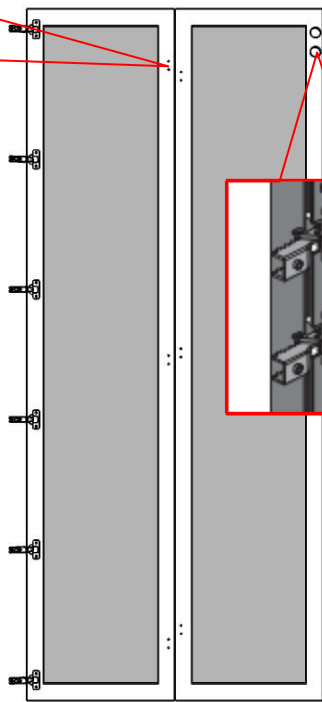
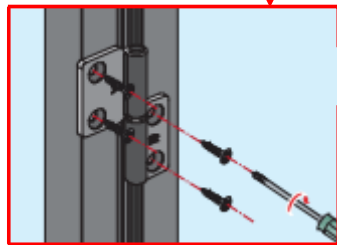

Türscharniere montieren  
Install door panel fittings

1

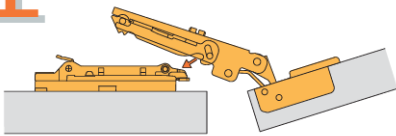

2

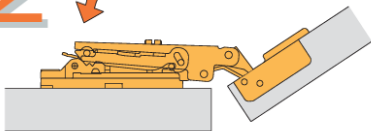

Türen positionieren und die Scharniere einhängen.  
Position doors and clip on hinges.

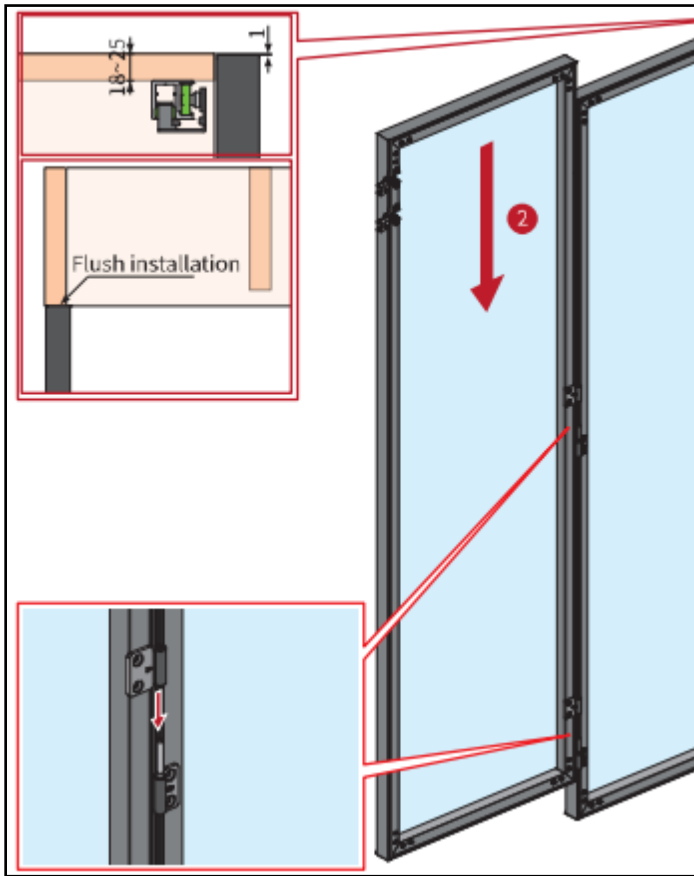

Tür einbauen  
Install door panel

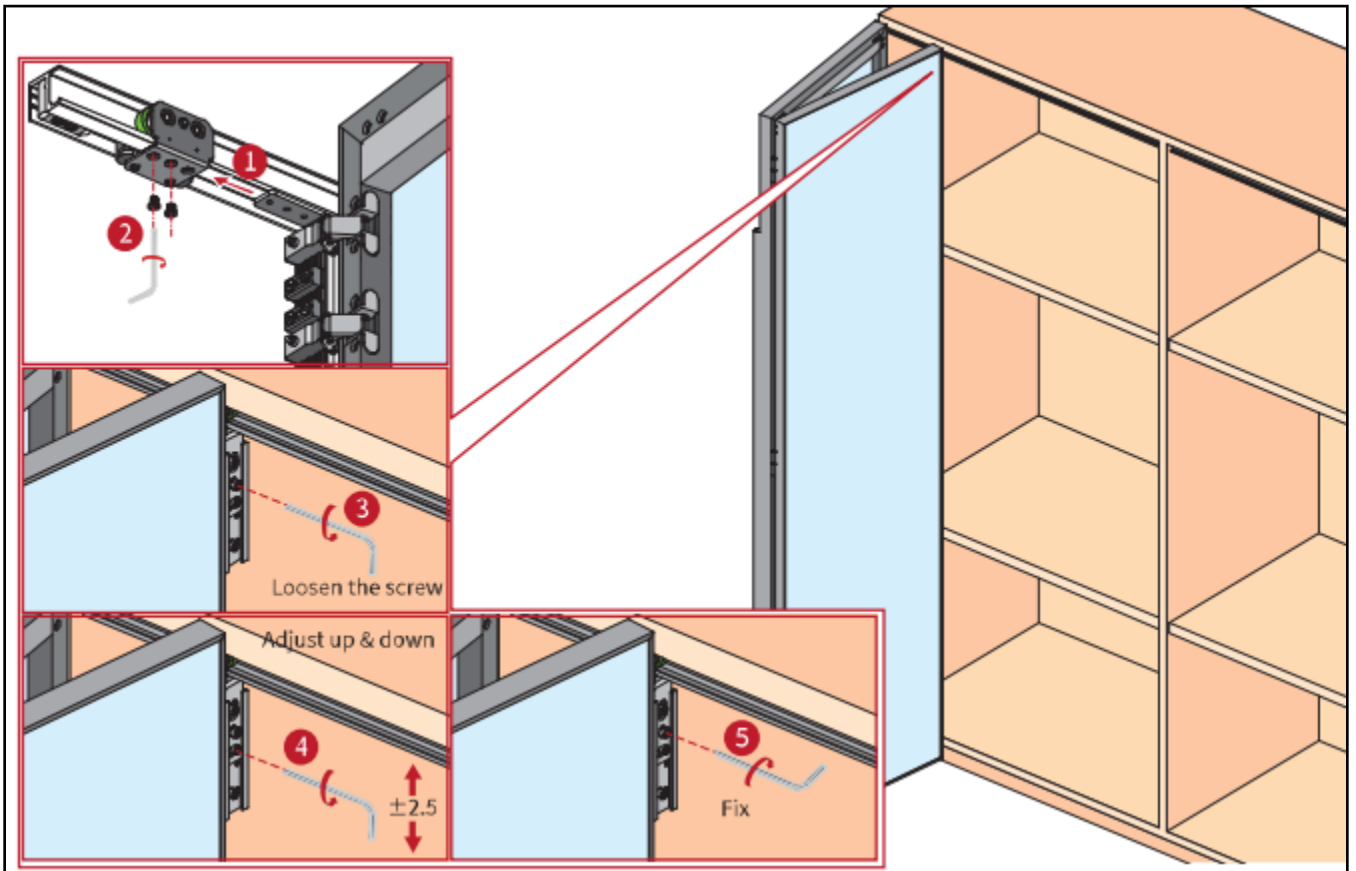

Justieren des Türblatts  
Adjust the balance of the door panel

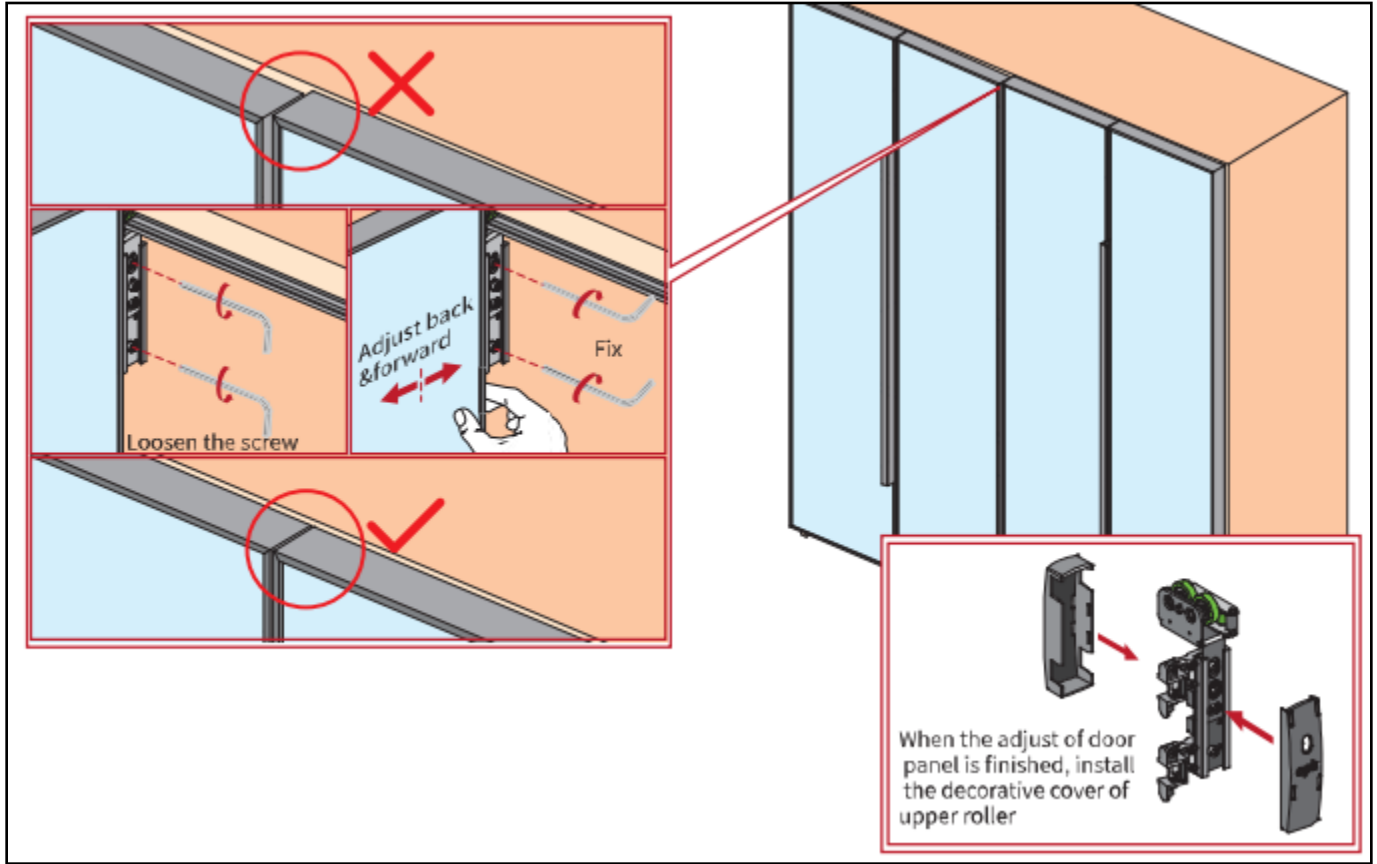

## Justieren des Türblatts

Adjust the balance of the door panel

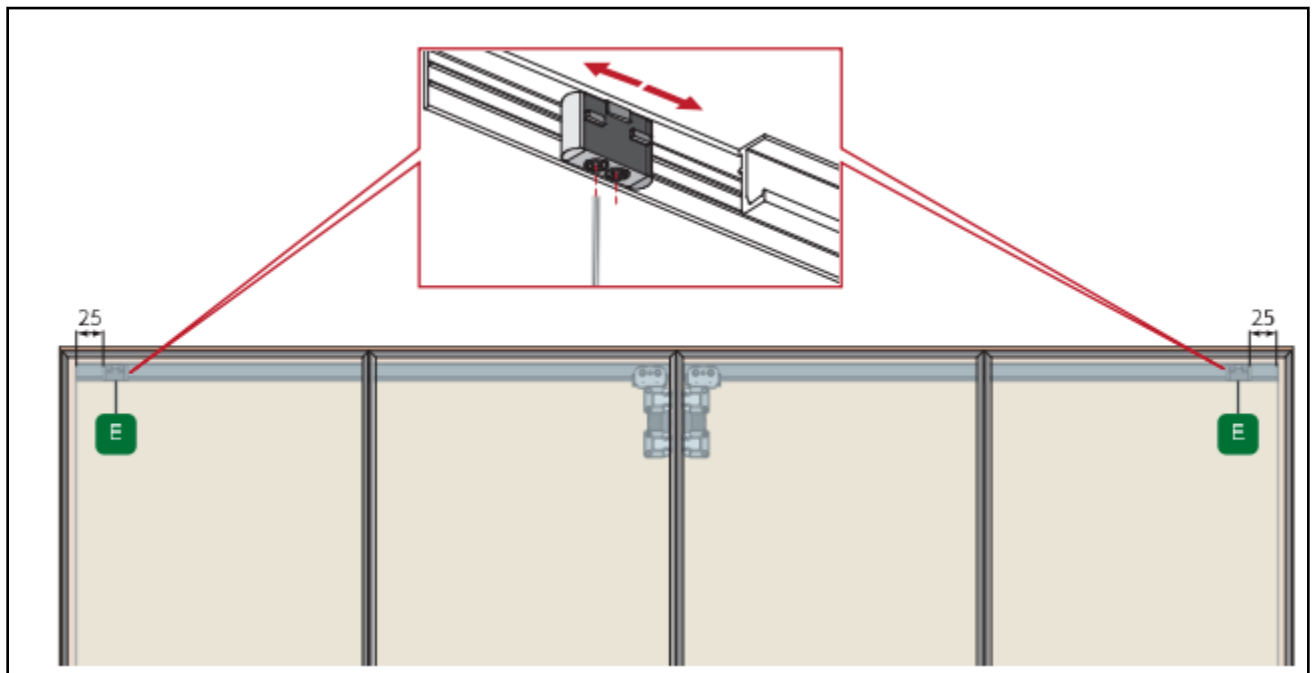

## Standortstopper

Location stopper

## 10. Platzierung Kleiderlift.

Placement hanging rod.

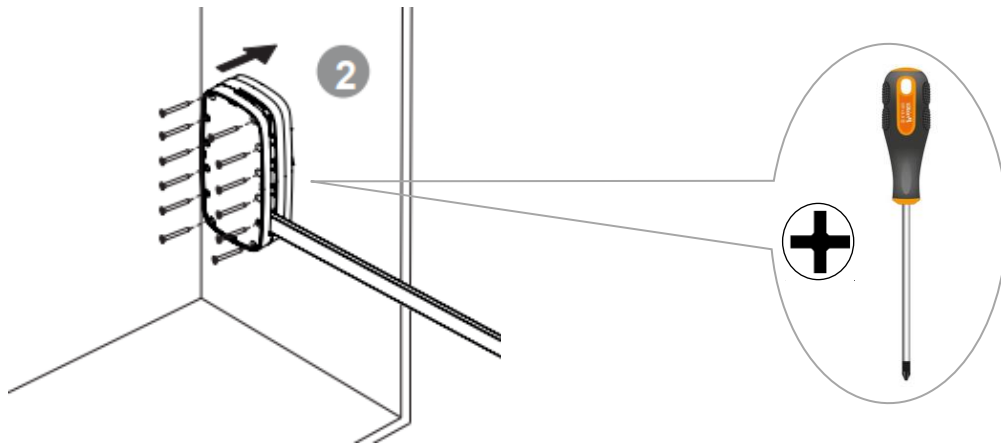

Kleiderlift positionieren und an den Seiten festziehen.  
Position hanging rod and tighten on sides.

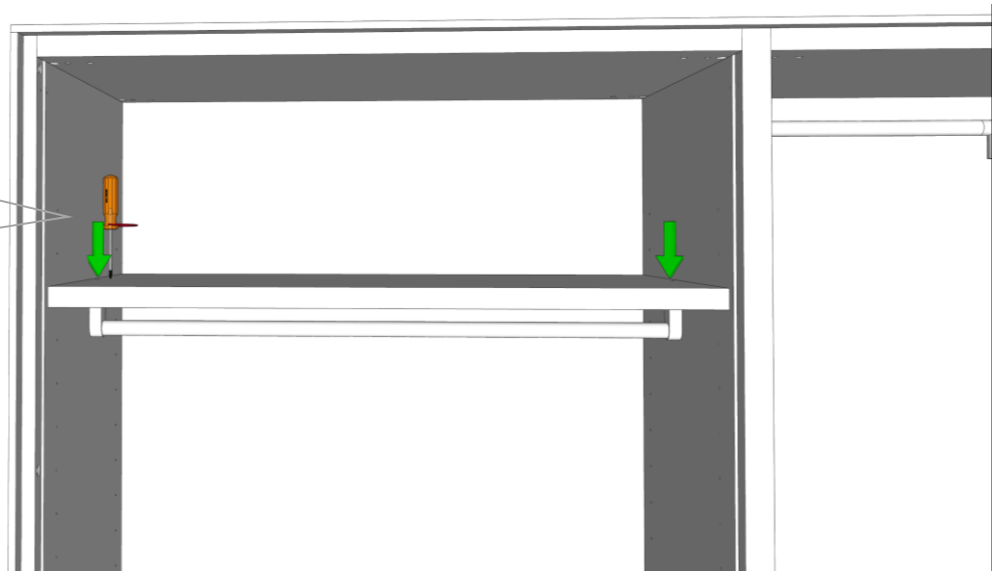
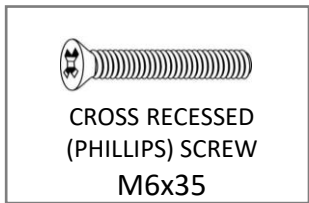

Die Stangenhalterung positionieren und festziehen, dann die Stange einsetzen.

Position rod support and tighten, then place rod.



# 11. Platzierung der Griffe

Placement handles

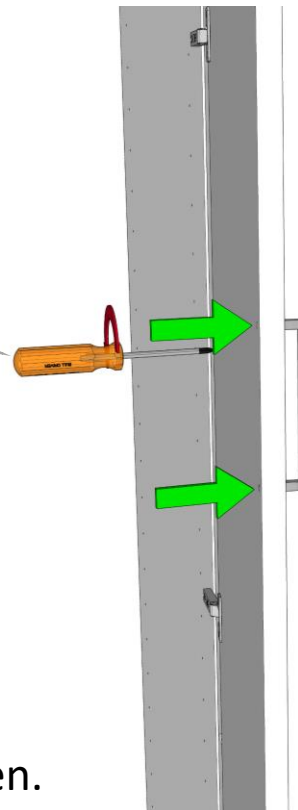
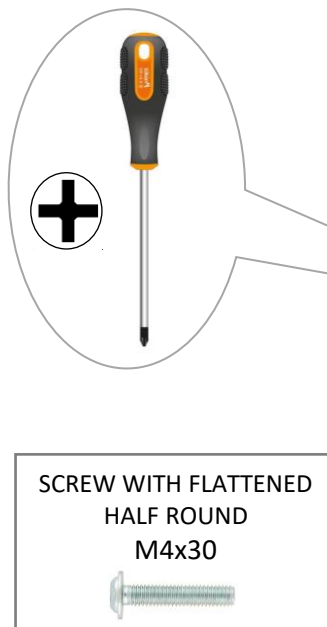
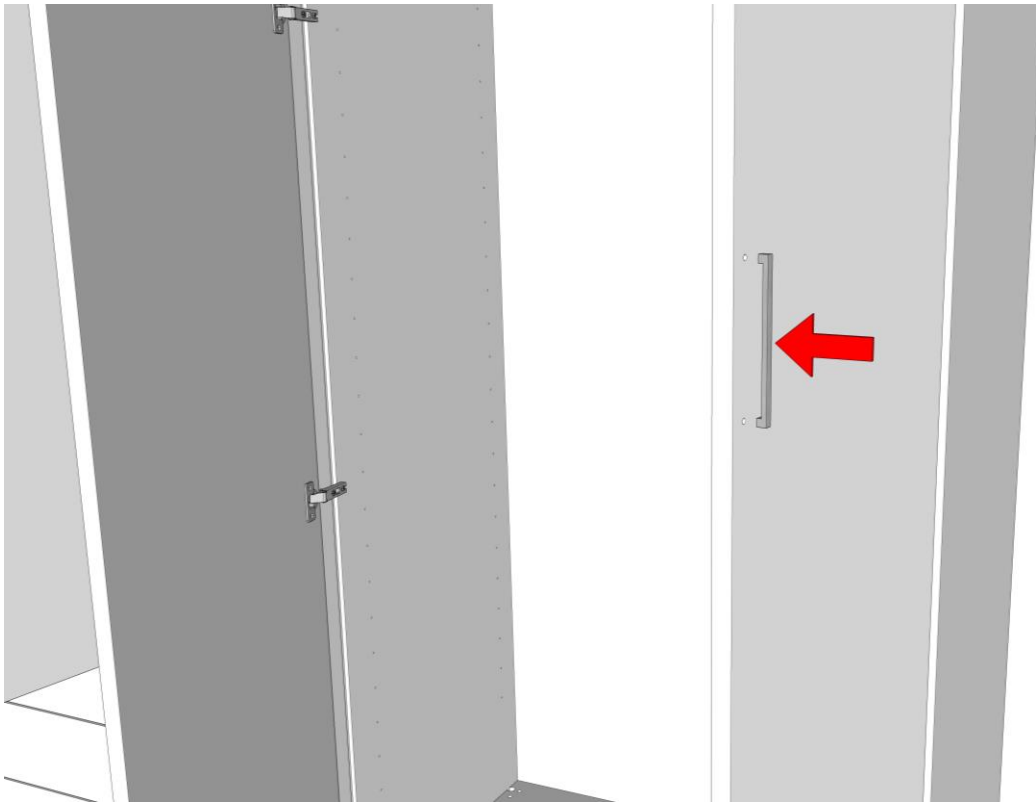

Griffe positionieren und festziehen.  
Positioning handles and tighten.

## 12. Anschluss-LEDs

### Connection LEDs

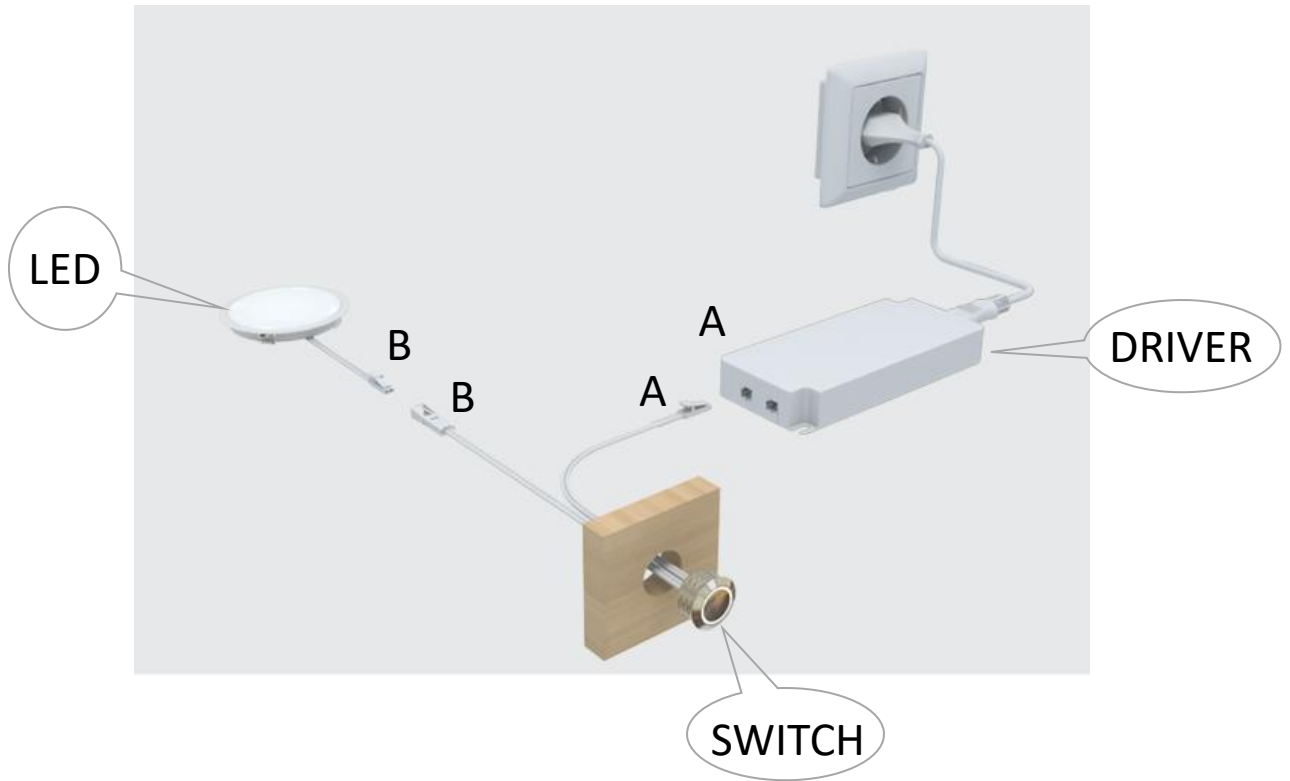

Anschlüsse nach Herstellervorschrift herstellen (Beschriftung).  
Make connections as indicated (lettering).

Beispiele:

Examples:

A-A

B-B

C-C

.....